

CLEAR CREEK WELCOME CENTER

INDIANA DEPARTMENT OF TRANSPORTATION

DRAWING SET #5 CIVIL SITE (SPECIFICATIONS VOLUMES 1, 5)

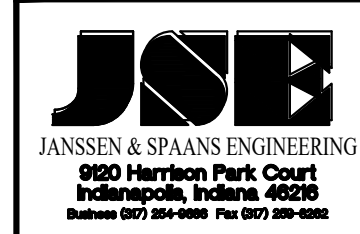
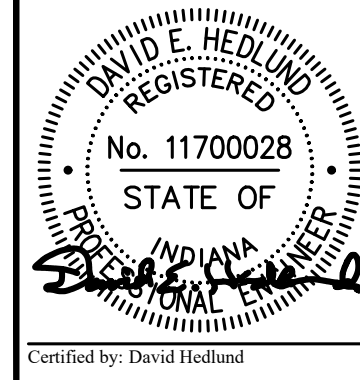
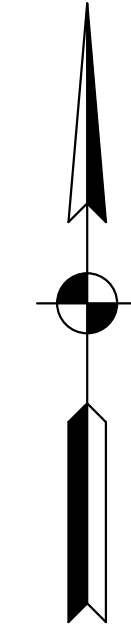

PUBLIC WORKS PROJECT NO. 84003001-22-058-C1
 CLEAR CREEK WELCOME CENTER
 VIGO COUNTY, INDIANA

STATE OF INDIANA
 DEPARTMENT OF ADMINISTRATION
PUBLIC WORKS DIVISION
 ROOM W407, INDIANA GOVERNMENT CENTER SOUTH
 402 WEST WASHINGTON STREET
 INDIANAPOLIS, INDIANA 46204
 317-232-3000

Revisions: 03/28/2023
 Revised Utility Data

Project Number: 84003001-22-058-C1
 Requisition Number:
 Account Number:
 Designer: DEH Drawing Date: 02/23/2023
 Drafter: MDR Drawing Scale: N/A
 DAPW Approval:
 Client Approval:
 Reference Number: 1364
 Building Reference:
 Drawing Number: G100
 Sheet: 1 of 155

UTILITIES				
SHEET INDEX	PROVIDER	PHONE	CONTACT	ADDRESS
ELECTRIC	DUKE ENERGY	(812) 231-8721 (OFFICE)	TYLER ANGLE (DISTRIBUTION)	301 HOME AVE. TERRE HAUTE, IN 47803
		(812) 249-7163 (M) (812) 375-2021	RYAN DAUGHARTY (TRANSMISSION)	2727 CENTRAL AVE. COLUMBUS, IN. 47201
WATER & SEWER	TOWN OF WEST TERRE HAUTE	(812) 533-1053 (OFFICE) (812) 870-5950 (M)	ED STEWART	500 W. NATIONAL AVE WEST TERRE HAUTE, IN 47885
INTERNET	FRONTIER	(219) 213-8608 (260) 415-9328	PERRY BYERS DAN KOCH	2727 Central Ave. Columbus. In. 47201
NATURAL GAS	CENTERPOINT ENERGY	(812) 231-6303	JENNIFER ISBELL-SCOTT	475 S. 1ST. ST TERRE HAUTE, IN 47807

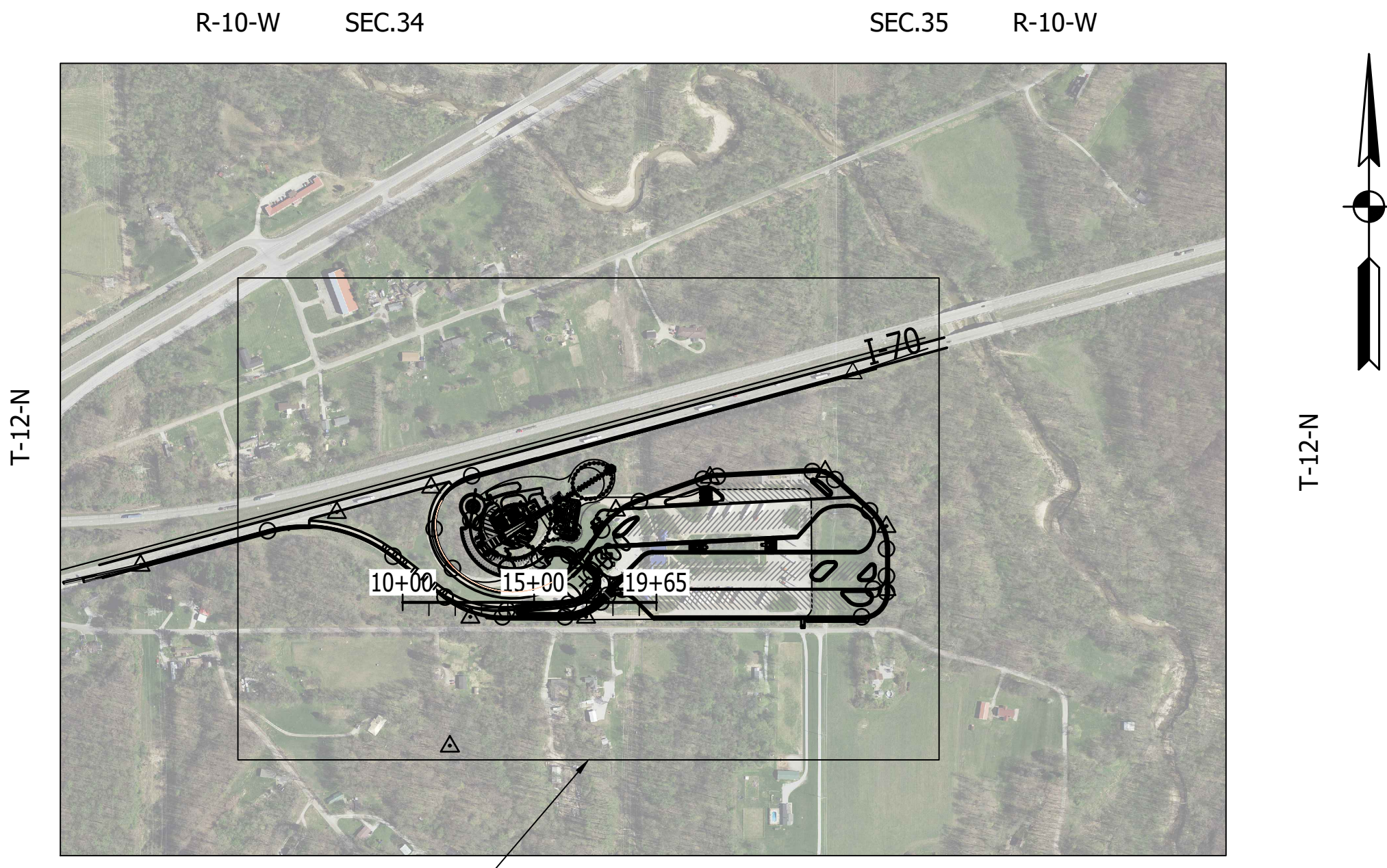

Project Location
 VIGO COUNTY, INDIANA
 VICINITY MAP
 SCALE: 1" = 100'



MARCH 2023

INDIANA DEPARTMENT OF TRANSPORTATION
 STANDARD SPECIFICATIONS DATED 2020,
 RECOMMENDED STANDARDS FOR WASTEWATER FACILITIES
 DATED 2014 (10 STATE STANDARDS) AND
 RECOMMENDED STANDARDS FOR WATER WORKS
 DATED 2018 (10 STATE STANDARDS)
 TO BE USED WITH THESE PLANS

Last Saved By: mreed Printed: 3/28/23
 P:\1364 - Clear Creek Welcome Center\WORKS\SITE SHEETS\508 WELCOME CENTER\1364-EB-0100 TITLE SHEET.dwg Mar 28, 2023 - 10:58:44 am

SHEET INDEX

SITE CIVIL

1	G-100	COVER SHEET	62	C-400	SITE UTILITY PLANS	123	CS-136	INDOT STANDARD DRAWING
2	G-101	SHEET INDEX	63	C-401	SITE UTILITY PLANS	124	CS-137	INDOT STANDARD DRAWING
3	G-102	MAINTENANCE OF TRAFFIC	64	C-402	SITE UTILITY PLANS	125	CS-138	INDOT STANDARD DRAWING
4	D-100	SITE DEMOLITION PLANS	65	C-500	SMALL SIGNS & PAVEMENT MARKINGS LAYOUT	126	CS-139	INDOT STANDARD DRAWING
5	D-101	SITE DEMOLITION PLANS	66	C-501	SMALL SIGNS & PAVEMENT MARKINGS LAYOUT	127	CS-140	INDOT STANDARD DRAWING
6	C-100	SITE PLAN OVERALL (CLEAR CREEK WELCOME CENTER)	67	C-502	SMALL SIGNS & PAVEMENT MARKINGS LAYOUT	128	CS-141	INDOT STANDARD DRAWING
7	C-101	SITE PLAN GEOMETRY	68	C-503	SHEET SIGNS & POST SUMMARY TABLE	129	CS-142	INDOT STANDARD DRAWING
8	C-102	SITE PLAN GEOMETRY	69	C-504	DELETED	130	CS-143	INDOT STANDARD DRAWING
9	C-103	SITE TYPICAL SECTIONS	70	C-600	SITE LIGHTING & ITS LAYOUT	131	CS-144	INDOT STANDARD DRAWING
10	C-104	SITE PLANS	71	C-601	SITE LIGHTING & ITS LAYOUT	132	CS-145	INDOT STANDARD DRAWING
11	C-105	SITE PLANS	72	C-602	LIGHTING LUMINAIRE SCHEDULE	133	CS-146	INDOT STANDARD DRAWING
12	C-106	SITE PLANS	73	C-603	LIGHTING FOUNDATION DETAILS	134	CS-147	INDOT STANDARD DRAWING
13	C-107	SITE PROFILES	74	C-604	LIGHTING PHOTOCELL DIAGRAM	135	CS-148	INDOT STANDARD DRAWING
14	C-108	SITE PROFILES	75	C-605	ITS DETAILS & GENERAL NOTES	136	CS-149	INDOT STANDARD DRAWING
15	C-109	NOT USED	76	C-606	ITS FIBER MAP	137	CS-150	INDOT STANDARD DRAWING
16	C-110	SITE PROFILES	77	C-700	SITE STORMWATER MANAGEMENT PLANS	138	CS-151	INDOT STANDARD DRAWING
17	C-111	SITE PLAN DETAILS (BUILDING & AUTO PARKING)	78	C-701	SITE STORMWATER MANAGEMENT PLANS	139	CS-152	INDOT STANDARD DRAWING
18	C-112	SITE PLAN DETAILS (ROUNDOABOUT DETAIL)	79	C-702	TEMPORARY EROSION CONTROL TABLE	140	CS-153	INDOT STANDARD DRAWING
19	C-113	SITE PLAN DETAILS (WINNERS' WALK)	80	C-703	NOT USED	141	CS-154	INDOT STANDARD DRAWING
20	C-114	SITE PLAN DETAILS (TRUCK PARKING LOT)	81	C-800	D-1 JOINT LAYOUT PLAN	142	CS-155	INDOT STANDARD DRAWING
21	C-115	SITE PLAN DETAILS (TRUCK LOT & CENTER ISLAND)	82	C-801	D-1 JOINT LAYOUT PLAN	143	CS-156	INDOT STANDARD DRAWING
22	C-116	SITE PLAN DETAILS (TRUCKER ISLAND LAYOUT & GRADES)	83	C-802	NOT USED	144	CS-157	INDOT STANDARD DRAWING
23	C-117	SITE PLAN DETAILS (TRUCKER ISLAND LAYOUT & GRADES)	84	C-900	SITE WATER LINE LAYOUT	145	CS-158	INDOT STANDARD DRAWING
24	C-118	SITE PLAN DETAILS (SANITARY LIFT STATION LAYOUT)	85	C-901	SITE WATER LINE LAYOUT	146	CS-159	INDOT STANDARD DRAWING
25	C-119	SITE PLAN DETAILS (TRUCKER RESTROOM LAYOUTS)	86	C-902	WATER MAIN DETAILS	147	CS-160	INDOT STANDARD DRAWING
26	C-120	SITE PLAN DETAILS (CURB RAMP 1 & 2 DETAIL)	87	CS-100	INDOT STANDARD DRAWING	148	CS-161	INDOT STANDARD DRAWING
27	C-121	SITE PLAN DETAILS (CURB RAMP 3 & 4 DETAIL)	88	CS-101	INDOT STANDARD DRAWING	149	CS-162	INDOT STANDARD DRAWING
28	C-122	SITE PLAN DETAILS (CURB RAMP 5 & 6 DETAIL)	89	CS-102	INDOT STANDARD DRAWING	150	CS-163	INDOT STANDARD DRAWING
29	C-123	SITE PLAN DETAILS (CURB RAMP 7 & 8 DETAIL)	90	CS-103	INDOT STANDARD DRAWING	151	CS-164	INDOT STANDARD DRAWING
30	C-124	SITE PLAN DETAILS (CURB RAMP 9 & 10 DETAIL)	91	CS-104	INDOT STANDARD DRAWING	152	CS-165	INDOT STANDARD DRAWING
31	C-125	SITE PLAN DETAILS (CURB RAMP 11 DETAIL)	92	CS-105	INDOT STANDARD DRAWING	153	CS-166	INDOT STANDARD DRAWING
32	C-126	DELETED	93	CS-106	INDOT STANDARD DRAWING	154	CS-167	INDOT STANDARD DRAWING
33	C-127	SITE PLAN DETAILS (WALKING PATH, DRIVEWAY & DITCH)	94	CS-107	INDOT STANDARD DRAWING	155	CS-168	INDOT STANDARD DRAWING
34	C-128	SITE PLAN DETAILS (STORAGE BUILDING PAVING PLAN)	95	CS-108	INDOT STANDARD DRAWING			
35	C-129	SITE PLAN DETAILS (BARRIER WALL DETAILS)	96	CS-109	INDOT STANDARD DRAWING			
36	C-130	SITE PLAN DETAILS (CATCH FENCE DETAIL)	97	CS-110	INDOT STANDARD DRAWING			
37	C-131	SITE PLAN DETAILS (DUMPSTER ENCLOSURE, PAD)	98	CS-111	INDOT STANDARD DRAWING			
37A	C-132	SITE PLAN DETAILS (PYLON DETAILS)	99	CS-112	INDOT STANDARD DRAWING			
38	C-200	SITE GRADING PLANS	100	CS-113	INDOT STANDARD DRAWING			
39	C-201	SITE GRADING PLANS	101	CS-114	INDOT STANDARD DRAWING			
40	C-202	SITE GRADING PLANS	102	CS-115	INDOT STANDARD DRAWING			
41	C-203	SITE GRADING PLANS	103	CS-116	INDOT STANDARD DRAWING			
42	C-204	SITE GRADING PLANS	104	CS-117	INDOT STANDARD DRAWING			
43	C-205	SITE GRADING PLANS	105	CS-118	INDOT STANDARD DRAWING			
44	C-206	TOPSOIL STOCKPLIE PLAN	106	CS-119	INDOT STANDARD DRAWING			
45	C-300	SITE DRAINAGE LAYOUT	107	CS-120	INDOT STANDARD DRAWING			
46	C-301	SITE DRAINAGE LAYOUT	108	CS-121	INDOT STANDARD DRAWING			
47	C-302	WELCOME CENTER DRAINAGE DETAILS	109	CS-122	INDOT STANDARD DRAWING			
48	C-303	TRUCKER RESTROOM DRAINAGE DETAILS	110	CS-123	INDOT STANDARD DRAWING			
49	C-304	TRUCKER RESTROOM DRAINAGE DETAILS	111	CS-124	INDOT STANDARD DRAWING			
50	C-305	DRAINAGE STRUCTURE DETAILS	112	CS-125	INDOT STANDARD DRAWING			
51	C-306	DRAINAGE STRUCTURE DETAILS	113	CS-126	INDOT STANDARD DRAWING			
52	C-307	DRAINAGE STRUCTURE DETAILS	114	CS-127	INDOT STANDARD DRAWING			
53	C-308	DRAINAGE STRUCTURE DETAILS	115	CS-128	INDOT STANDARD DRAWING			
54	C-309	TRENCH DRAIN DETAILS	116	CS-129	INDOT STANDARD DRAWING			
55	C-310	UNDERDRAIN TABLE	117	CS-130	INDOT STANDARD DRAWING			
56	C-311	UNDERDRAIN TABLE	118	CS-131	INDOT STANDARD DRAWING			
57	C-312	UNDERDRAIN TABLE	119	CS-132	INDOT STANDARD DRAWING			
58	C-313	STRUCTURE DATA TABLE	120	CS-133	INDOT STANDARD DRAWING			
59	C-314	STRUCTURE DATA TABLE	121	CS-134	INDOT STANDARD DRAWING			
60	C-315	PIPE MATERIAL TABLE	122	CS-135	INDOT STANDARD DRAWING			
61	C-316	PIPE MATERIAL TABLE						

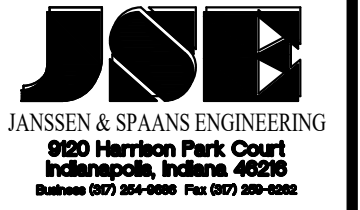
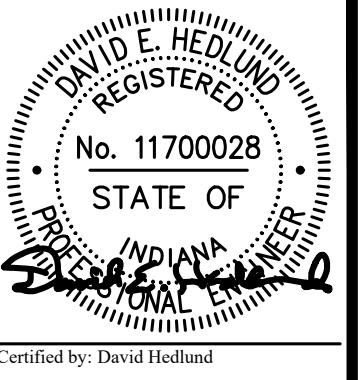

PUBLIC WORKS PROJECT NO. 84003001-22-058-C1
 CLEAR CREEK WELCOME CENTER
 WEST TERRA HAUTE, VIGO COUNTY, INDIANA



STATE OF INDIANA
 DEPARTMENT OF ADMINISTRATION
PUBLIC WORKS DIVISION
 ROOM 9407, INDIANA GOVERNMENT CENTER SOUTH
 402 WEST WASHINGTON STREET
 INDIANAPOLIS, INDIANA 46204
 317-232-3000



Revisions: 03/28/2023
 Deleted Sheet C126
 & C504

Project Number: 84003001-22-058-C1

Requestion Number: -

Account Number: -

Designer: DEH Drawing Date: 02/23/2023

Drafter: MDR Drawing Scale: N/A

DAPW Approval: -

Client Approval: -

Reference Number: 1364

Building Reference: -

Drawing Number: G101

Sheet: 2 of 155

Begin Guardrail for 6' shoulder at match point on taper

78+00 80+00 85+00

9+14 10+00 15+00

Existing Guardrail

MATCHLINE SEE SHEET BELOW

LEGEND

(A) 12 Inch, QC/QA PCCP	(10) MGS, Guardrail	(#) Concrete Curb Ramp
(F) Sidewalk, Concrete, 4"	(13) Integral Concrete Curb (Vertical)	(28) Concrete Barrier, 45"
(F1) Utility Sidewalk, Concrete	(14) Concrete Curb, Modified	(29) Concrete Barrier W/ Catch Fence
(P) 4 Inch, PCCP	(15) Concrete Curb, Turnout	(30) Gravel Walking Path
(R) Mill And Resurface	(16) Concrete Curb, Notched	(32) 8" PCCP on 4" Comp. Agg. Base #53
(S) Joints in PCCP, Saw and Seal	(17) Rolled Curb	(33) Impact Attenuator (Quadguard II, 24")
T.C. = Top of Curb	(26) Sodding	(34) Wheel Stop
F.P. = Finished Pavement	(27) Chain Link Fence	(35) C.L. Gate
		(36) 15' x 8' Water Vault

Notes:

1. See Cell Tower details on Sht. C126
2. See Catch Fence details on Sht. C129
3. See Landscape Plans For Stamped Concrete Band Details.

SEC. 34 T12N, R01W
SUGAR CREEK TOWNSHIP
VIGO COUNTY
STATE OF INDIANA

MATCHLINE SEE ABOVE

MATCHLINE SEE SHEET C100

Plot Saved By: mreed Printdate: 3/28/23
P:\1364 - Clear Creek Welcome Center (MKS) SITE SHEETS\EB WELCOME CENTER\1364-EB-C101 SITE PLAN.dwg Mar 28, 2023 - 10:57:50 am

DAVID A. I. &
SALLY DEBNEY

MICHELLE K. WAGLE

MARK & JAMIE
EVERSOLE

JONATHANE &
VICTORIA DAWN
WAGNER

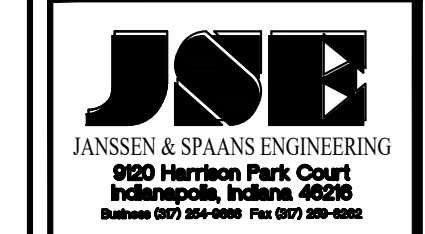
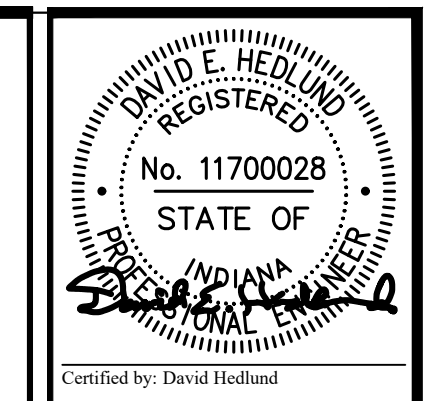
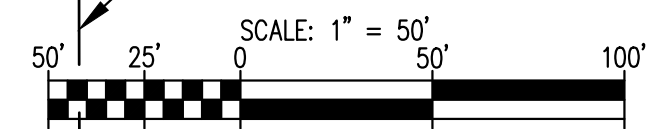

PUBLIC WORKS PROJECT NO. 84003001-22-058-C1
CLEAR CREEK WELCOME CENTER
VIGO COUNTY, INDIANA

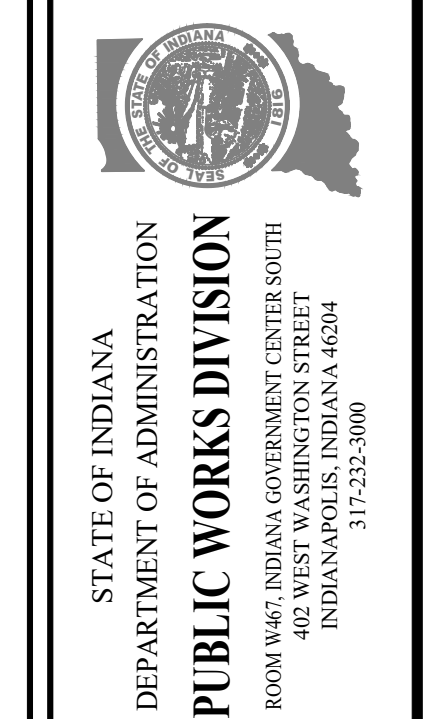

Revisions: 03/28/2023
Deleted Cell Tower & Note

Project Number:	84003001-22-058-C1
Requestion Number:	
Account Number:	
Designer:	DEH
Drawing Date:	02/23/2023
Drafter:	MDR
Drawing Scale:	1"=50'
DAPW Approval:	
Client Approval:	
Reference Number:	1364
Building Reference:	
Drawing Number:	C104
Sheet:	10 of 155

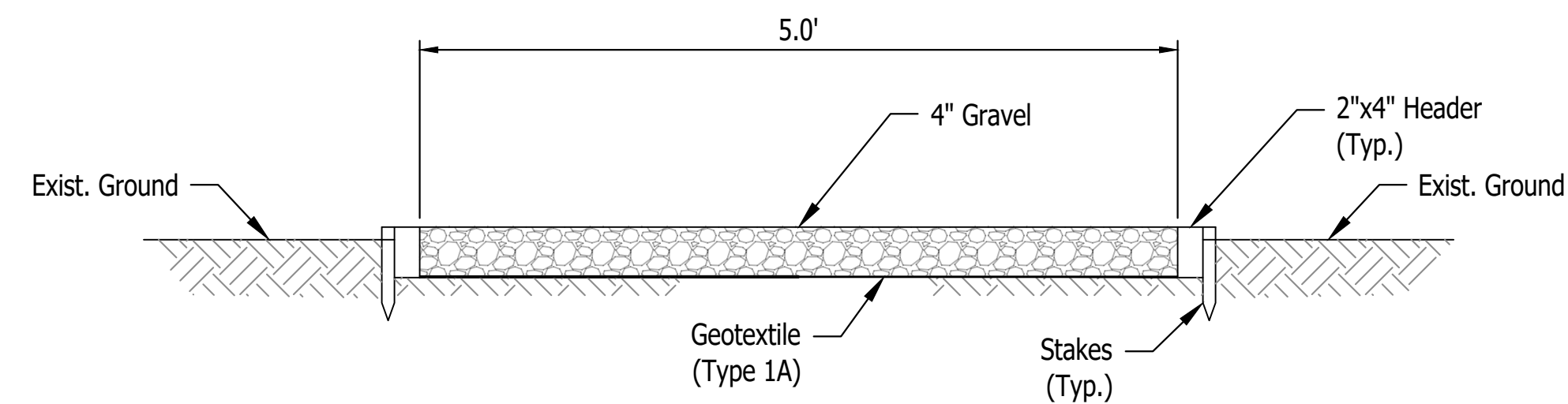

Notes:

1. The walking path is intended to meander thru the wooded area along the ridge between the ditch along I-70 and the intermittent stream.
2. The location of the pathway shall be cleared of all debris and organic material.
3. The 2"x4" header boards shall have stakes attached @ each end of boards.
4. Where walking path crosses low-lying areas subject to possible drainage flows, Contractor to place compacted fill and drainage pipes beneath walking path as directed by the Engineer.

4 Gravel shall consist of decomposed granite or approved equal.

WALKING PATH DETAIL
SCALE: None

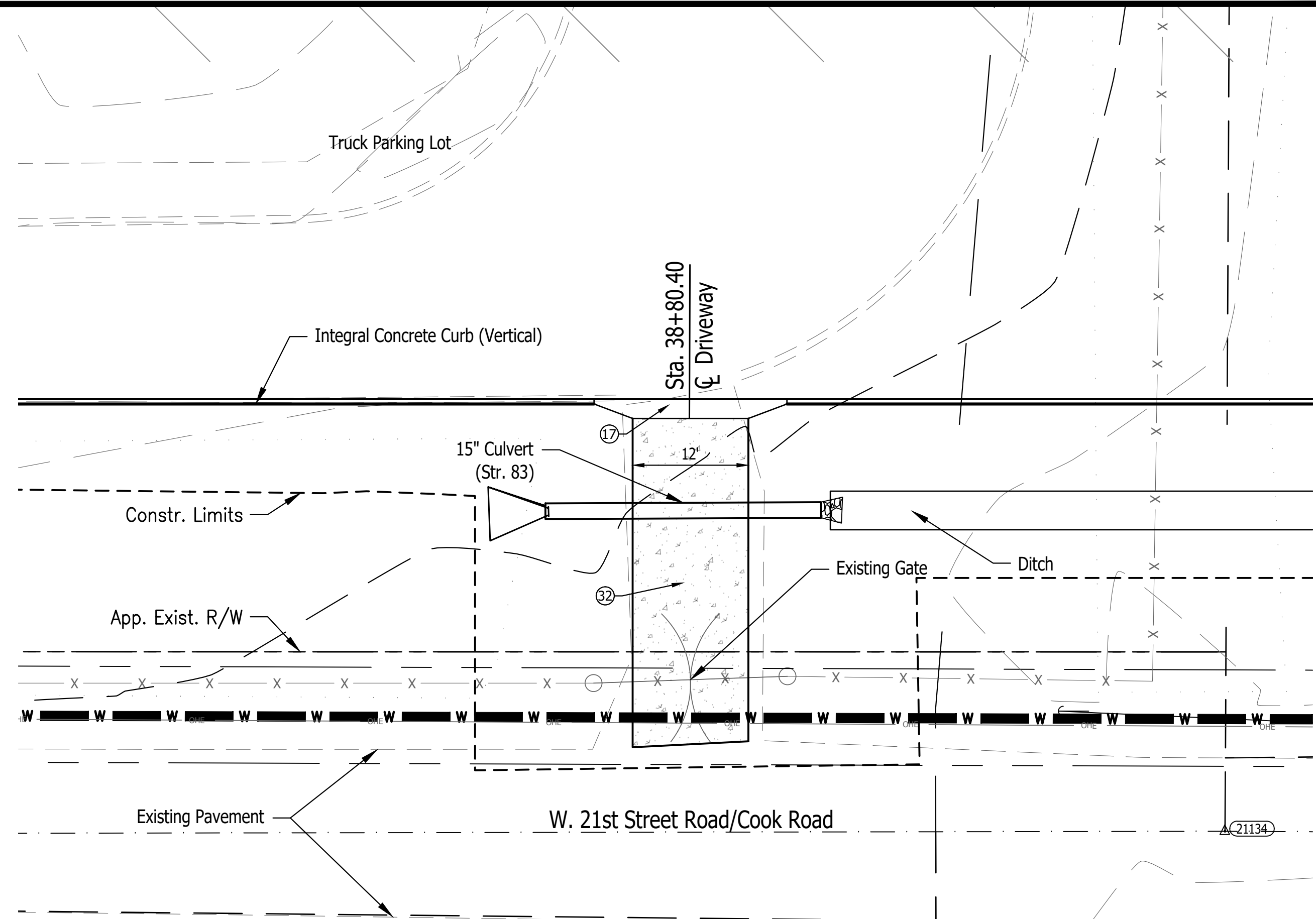

Notes:

1. Remove exist. & construct new 20' Chain link gate per INDOT Std. Dwg. E603-CLTF-03.
2. Construct 8" PCCP on 4" Aggregate Base Driveway. Match Existing Pavement on W. 21st Street Road.
3. Provide swale across driveway at location of proposed ditch.
4. Provide lock For Town of West Terre Haute
5. See ditch details on Sheet C127
6. See culvert details on Shts. C301 & C313

DRIVEWAY ACCESS DETAIL
SCALE : 1" = 10'

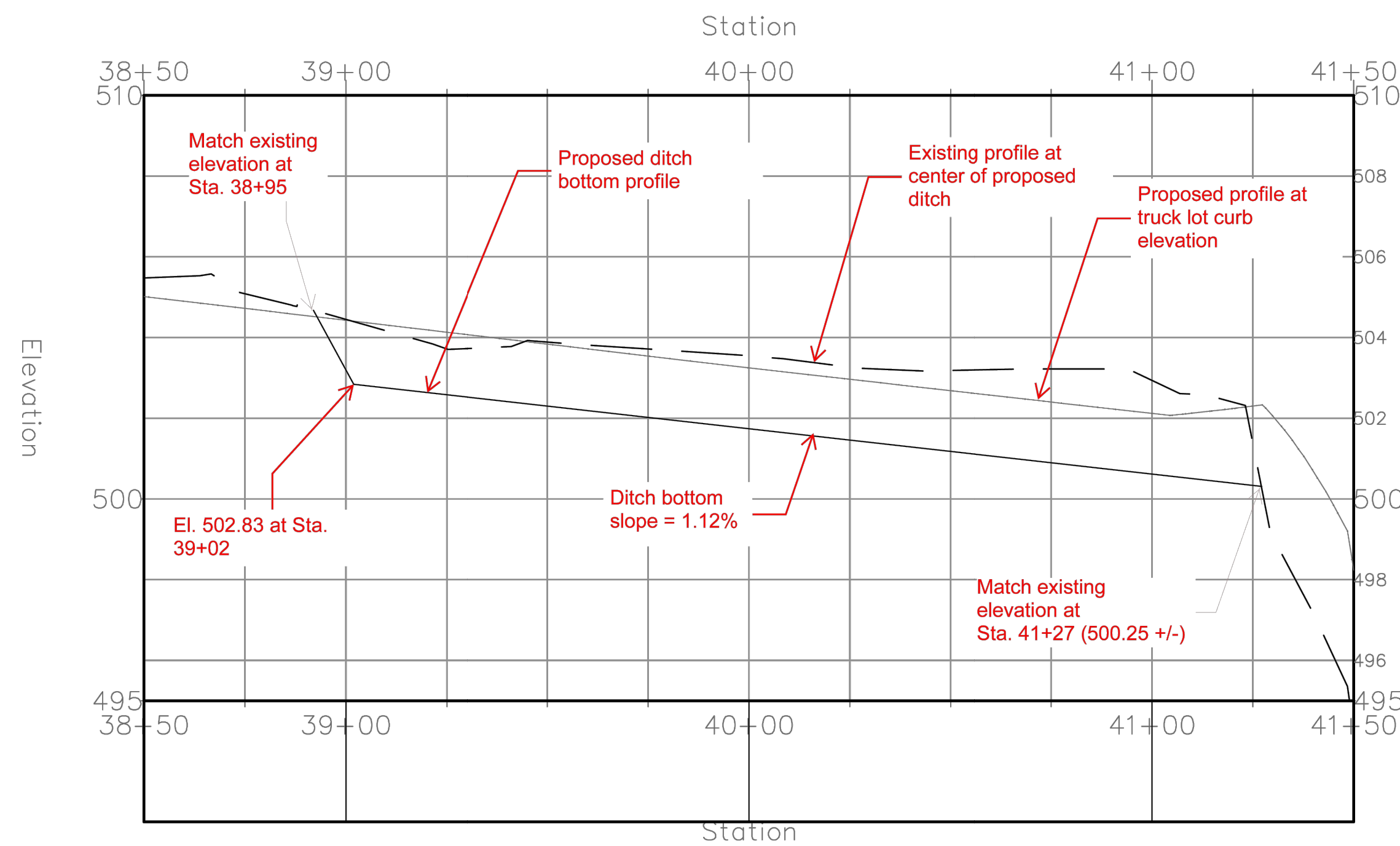

Ditch Profile
Scale : None

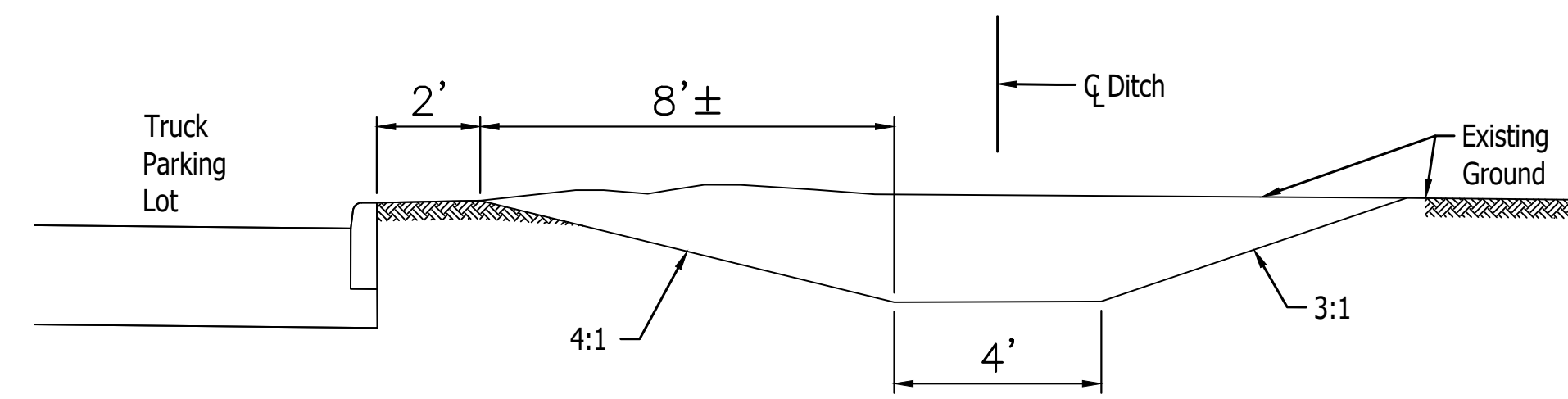

Ditch Typical Section
Scale : None

LEGEND

(A) 12 Inch, QC/QA PCCP	(10) MGS, Guardrail	(#) Concrete Curb Ramp
(F) Sidewalk, Concrete, 4"	(13) Integral Concrete Curb (Vertical)	(28) Concrete Barrier, 45"
(FI) Utility Sidewalk, Concrete	(14) Concrete Curb, Modified	(29) Concrete Barrier W/ Catch Fence
(P) 4 Inch, PCCP	(15) Concrete Curb, Turnout	(30) Gravel Walking Path
(R) Mill And Resurface	(16) Concrete Curb, Notched	(32) 8" PCCP on 4" Comp. Agg. Base #53
(S) Joints in PCCP, Saw and Seal	(17) Rolled Curb	(33) Impact Attenuator (Quadguard II, 24")
T.C. = Top of Curb	(26) Sodding	(34) Wheel Stop
F.P. = Finished Pavement	(27) Chain Link Fence	(35) C.L. Gate
		(36) 15' x 8' Water Vault

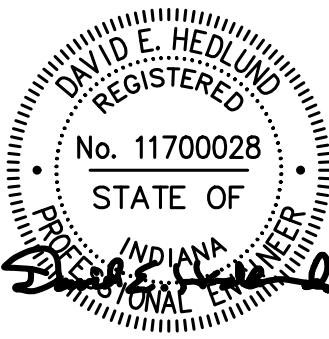

PUBLIC WORKS PROJECT NO. 84003001-22-058-C1
CLEAR CREEK WELCOME CENTER
VIGO COUNTY, INDIANA

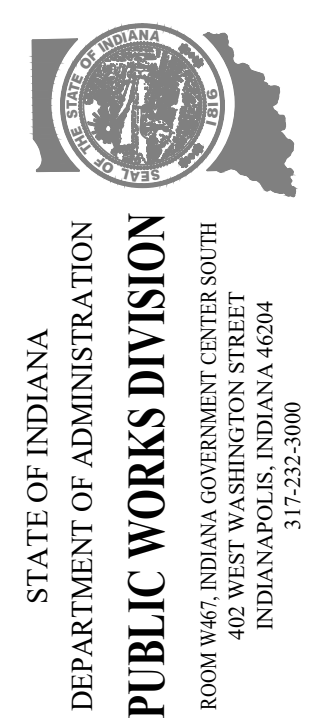

Revisions: 03/28/2023
Added note

Project Number: 84003001-22-058-C1
Requisition Number:

Account Number:

Designer: DEH Drawing Date: 02/23/2023
Drafter: MDR Drawing Scale: AS SHOWN

DAPW Approval:

Client Approval:

Reference Number: 1364

Building Reference:

Drawing Number: C127

Sheet: 33 of 155

Last Saved By: mreed Printed: 3/28/23
 P:\1364 - Clear Creek Welcome Center\WORKS\SITE SHEETS\JOB WELCOME CENTER\1364-EB-C200 GRADING PLAN.dwg Mar 28, 2023 - 10:58:41 am

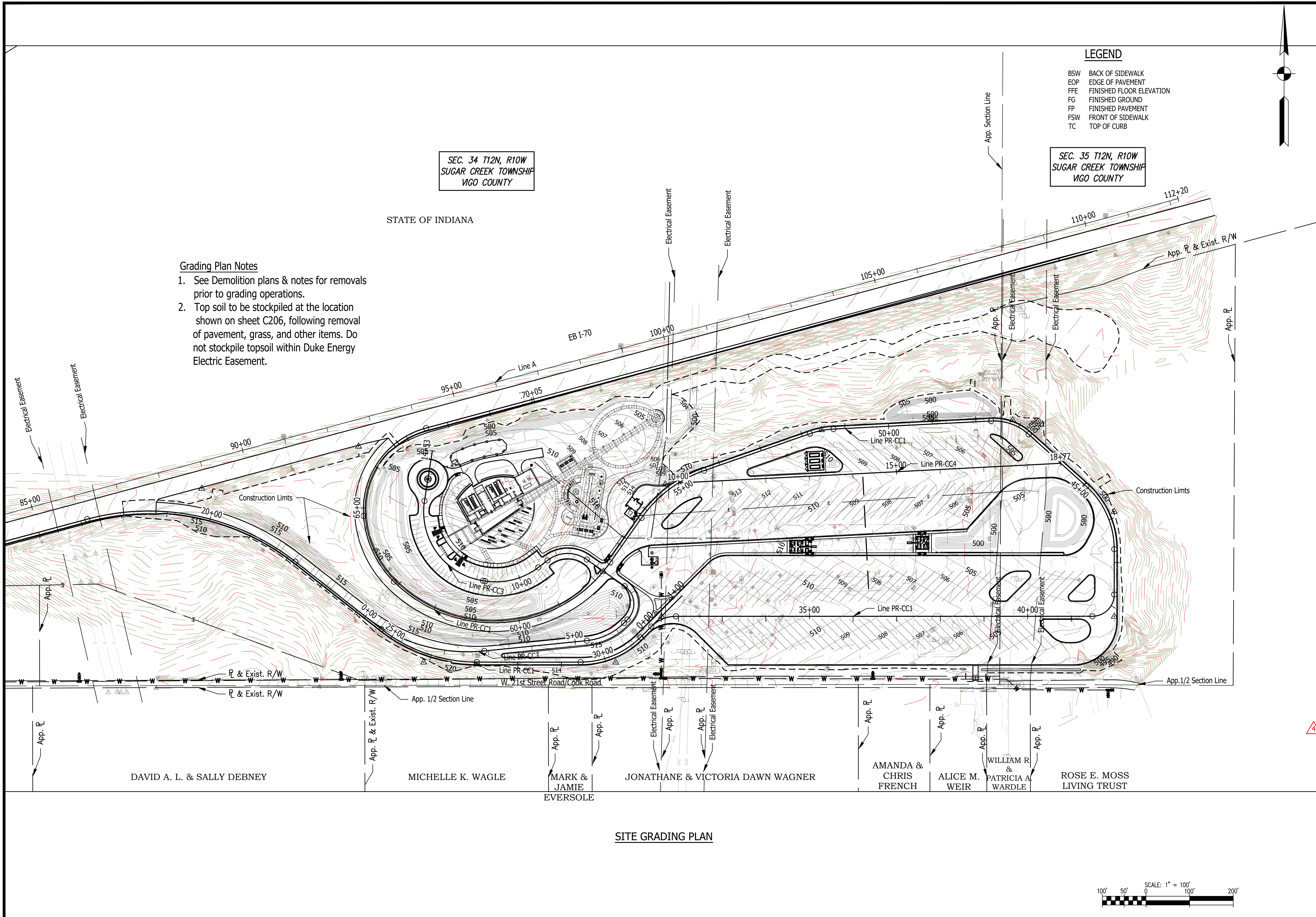

- Grading Plan Notes**
1. See Demolition plans & notes for removals prior to grading operations.
 2. Top soil to be stockpiled at the location shown on sheet C206, following removal of pavement, grass, and other items. Do not stockpile topsoil within Duke Energy Electric Easement.

LEGEND

BSW	BACK OF SIDEWALK
EOP	EDGE OF PAVEMENT
FFE	FINISHED FLOOR ELEVATION
FG	FINISHED GROUND
FP	FINISHED PAVEMENT
FSW	FRONT OF SIDEWALK
TC	TOP OF CURB

Certified by: David Hedlund

PUBLIC WORKS PROJECT NO. 84003001-22-058-C1
 CLEAR CREEK WELCOME CENTER
 VIGO COUNTY, INDIANA

STATE OF INDIANA
 DEPARTMENT OF ADMINISTRATION
PUBLIC WORKS DIVISION
 ROOM W407, INDIANA GOVERNMENT CENTER SOUTH
 402 WEST WASHINGTON STREET
 INDIANAPOLIS, INDIANA 46204
 317-232-3000

Revisions: 03/28/2023	
Added Existing Contours	
Project Number:	84003001-22-058-C1
Requestion Number:	
Account Number:	
Designer:	DEH
Drawing Date:	02/23/2023
Drafter:	MDR
Drawing Scale:	1"=100'
DAPW Approval:	
Client Approval:	
Reference Number:	1364
Building Reference:	
Drawing Number:	C200
Sheet:	38 of 155

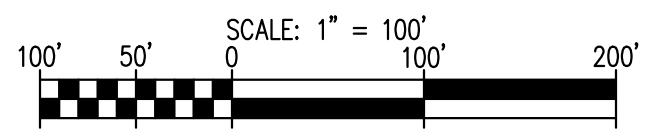

SITE GRADING PLAN

LEGEND

- BSW BACK OF SIDEWALK
- EOP EDGE OF PAVEMENT
- FFE FINISHED FLOOR ELEVATION
- FG FINISHED GROUND
- FP FINISHED PAVEMENT
- FSW FRONT OF SIDEWALK
- TC TOP OF CURB

Notes:

1. See Shts. C111 & C112 for Grades in Auto Parking Lot & Around Welcome Center Building.

SEC. 34 T12N, R10W
SUGAR CREEK TOWNSHIP
VIGO COUNTY

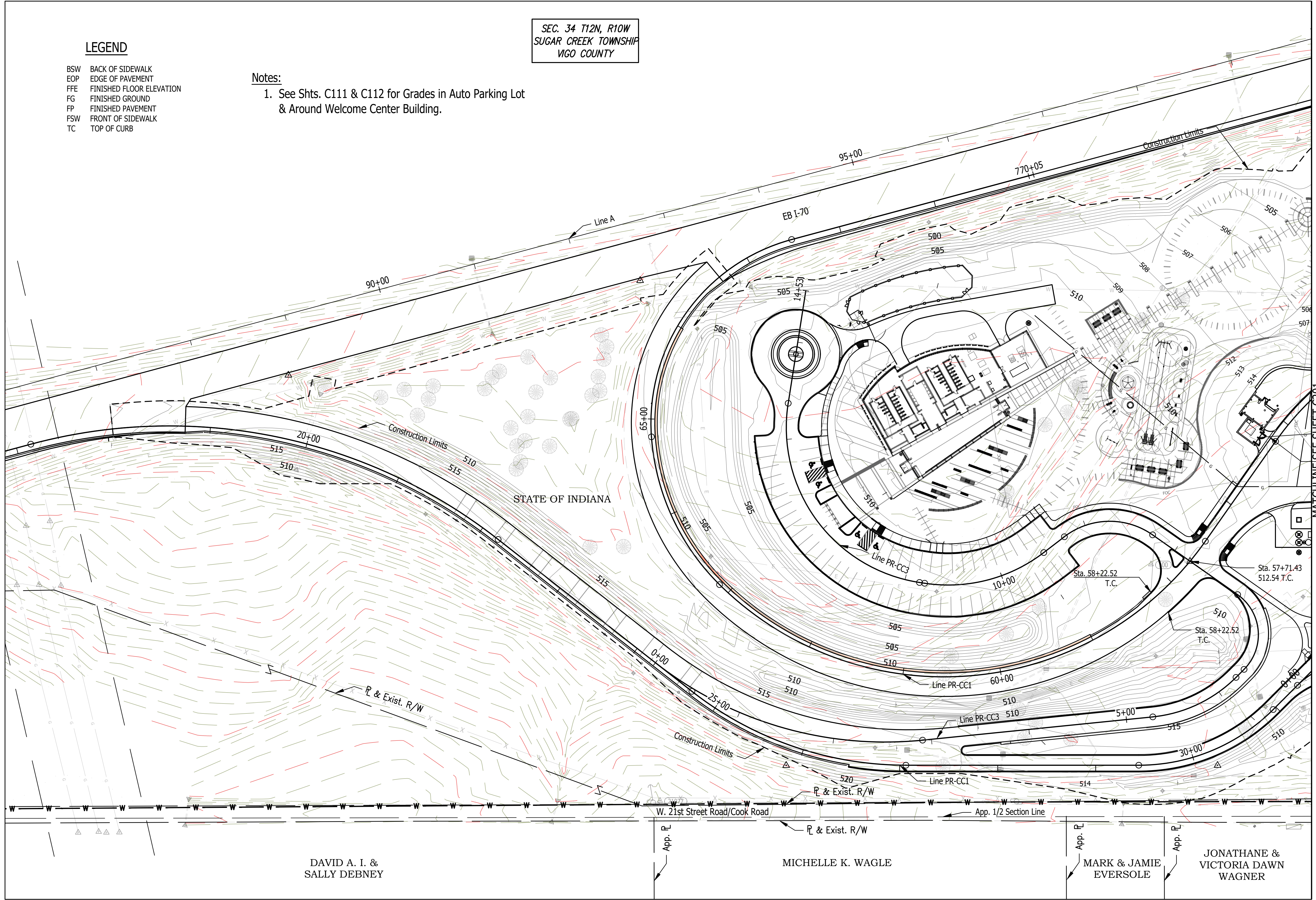

STATE OF INDIANA

W. 21st Street Road/Cook Road

DAVID A. I. &
SALLY DEBNEY

MICHELLE K. WAGLE

MARK & JAMIE
EVERSOLE

JONATHANE &
VICTORIA DAWN
WAGNER

SITE GRADING PLAN

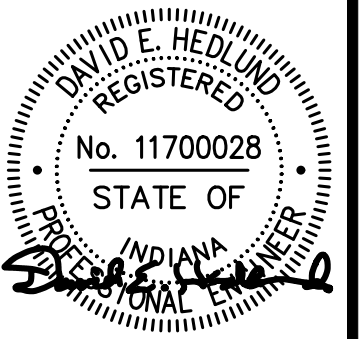
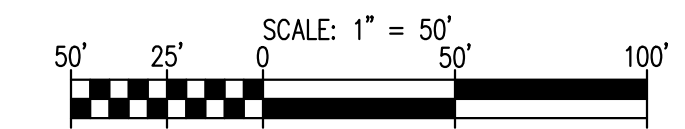

Certified by: David Hedlund

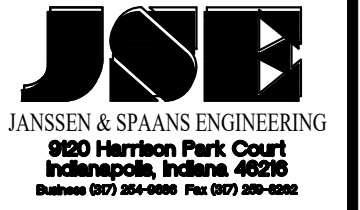

PUBLIC WORKS PROJECT NO. 84003001-22-058-C1
CLEAR CREEK WELCOME CENTER
VIGO COUNTY, INDIANA



STATE OF INDIANA
DEPARTMENT OF ADMINISTRATION
PUBLIC WORKS DIVISION
ROOM 9402, INDIANA GOVERNMENT CENTER SOUTH
402 WEST WASHINGTON STREET
INDIANAPOLIS, INDIANA 46204
317-232-3000

Revisions: 03/28/2023
Added Existing Contours

Project Number:
84003001-22-058-C1

Requestion Number:

Account Number:

Designer: DEH Drawing Date: 02/23/2023

Drafter: MDR Drawing Scale: 1"=50'

DAPW Approval:

Client Approval:

Reference Number: 1364

Building Reference:
Drawing Number:
C201
Sheet: 39 of 155

Last Saved By: mreed Printed: 3/29/23 P:\1364 - Clear Creek Welcome Center\WORKS\SITE SHEETS\EB WELCOME CENTER\1364-EB-C200 GRADING PLAN.dwg Mar 28, 2023 - 10:56:52 am

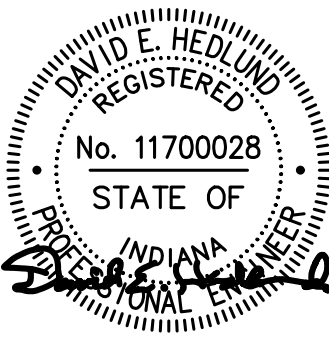

Certified by: David Hedlund

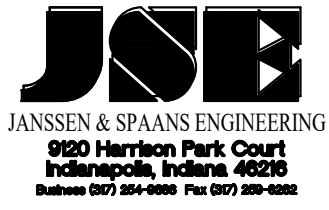

PUBLIC WORKS PROJECT NO. 84003001-22-058-C1
CLEAR CREEK WELCOME CENTER
VIGO COUNTY, INDIANA



STATE OF INDIANA
DEPARTMENT OF ADMINISTRATION
PUBLIC WORKS DIVISION
ROOM 4402, INDIANA GOVERNMENT CENTER SOUTH
402 WEST WASHINGTON STREET
INDIANAPOLIS, INDIANA 46204
317-232-3000

Revisions: 03/28/2023
Added Existing Contours

Project Number: 84003001-22-058-C1
Requisition Number:

Account Number:

Designer: DEH Drawing Date: 02/23/2023
Drafter: MDR Drawing Scale: 1"=50'

DAPW Approval:
Client Approval:

Reference Number: 1364

Building Reference:
Drawing Number:

C202
Sheet 40 of 155

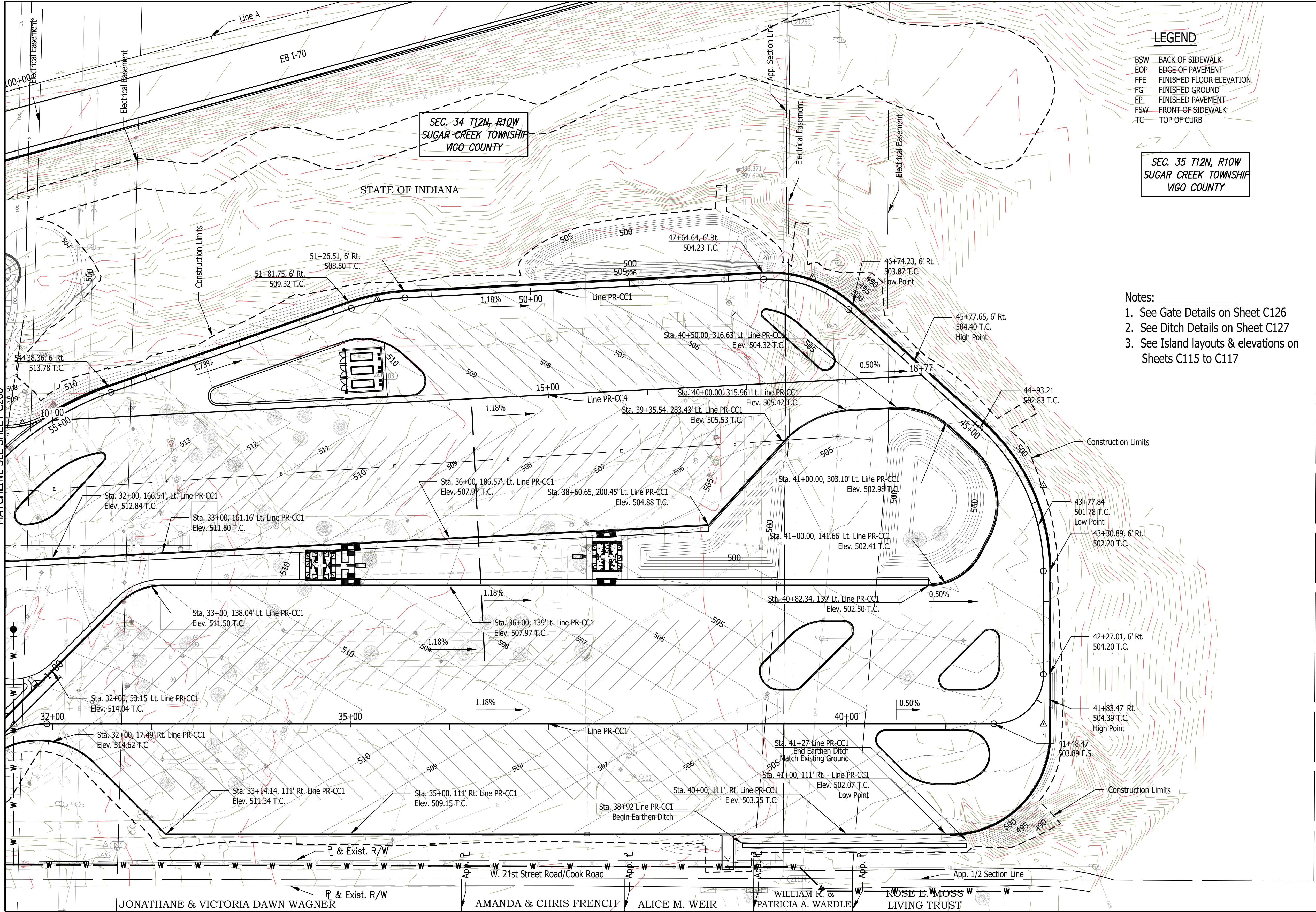

LEGEND

- BSW BACK OF SIDEWALK
- EOP EDGE OF PAVEMENT
- FFE FINISHED FLOOR ELEVATION
- FG FINISHED GROUND
- FP FINISHED PAVEMENT
- FSW FRONT-OF-SIDEWALK
- TC TOP OF CURB

- Notes:**
1. See Gate Details on Sheet C126
 2. See Ditch Details on Sheet C127
 3. See Island layouts & elevations on Sheets C115 to C117

SITE GRADING PLAN

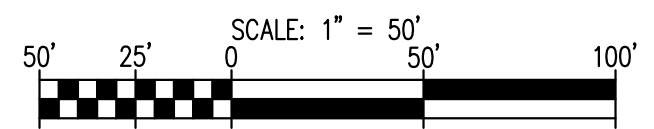

Plot Saved By: mreed Printed: 2/28/23
P:\1364 - Clear Creek Welcome Center\WORKS\SITE SHEETS\EB WELCOME CENTER\1364-EB-C200 GRADING PLAN.dwg Mar 28, 2023 - 11:00:01 am

Plot Saved By: mreed Printdate: 3/28/23
P:\1364 - Clear Creek Welcome Center\WORKS\SITE SHEETS\EB WELCOME CENTER\1364-EB-C200 GRADING PLAN.dwg Mar 28, 2023 - 1:00:11 am

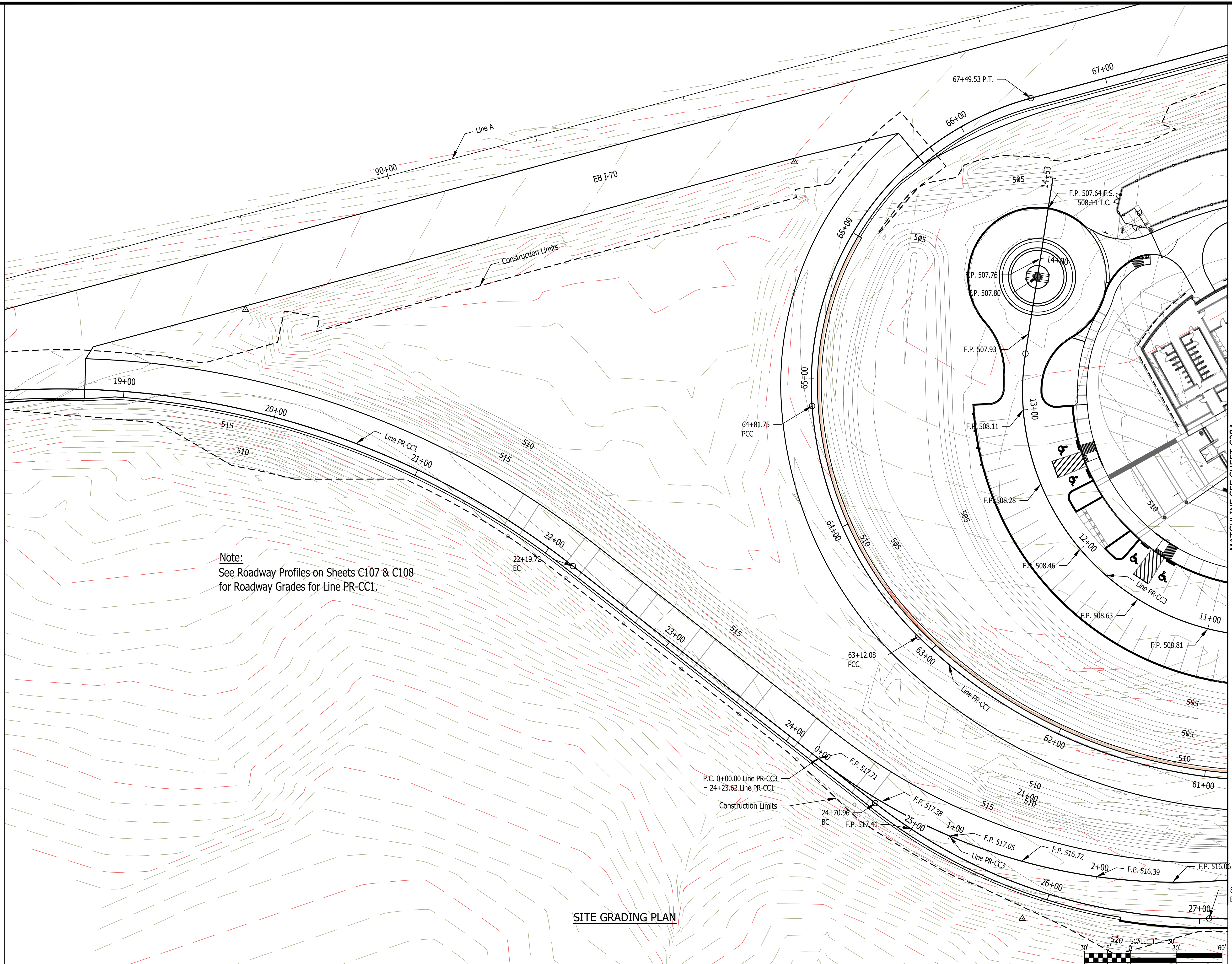

Note:
See Roadway Profiles on Sheets C107 & C108
for Roadway Grades for Line PR-CC1.

SITE GRADING PLAN

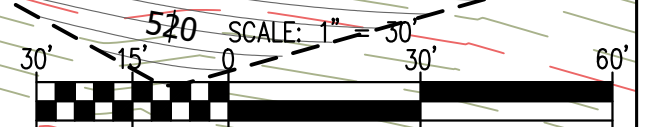

MATCHLINE SEE SHEET C204

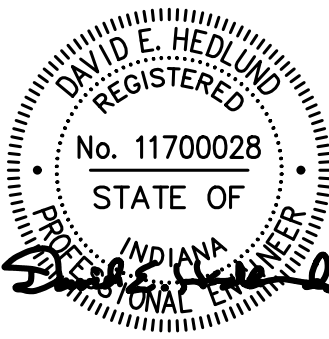
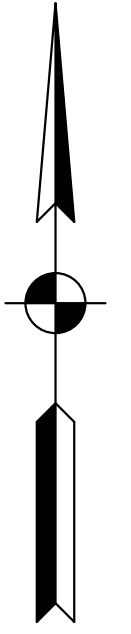

Certified by: David Hedlund



PUBLIC WORKS PROJECT NO. 84003001-22-058-C1
CLEAR CREEK WELCOME CENTER
VIGO COUNTY, INDIANA



STATE OF INDIANA
DEPARTMENT OF ADMINISTRATION
PUBLIC WORKS DIVISION
ROOM 940, INDIANA GOVERNMENT CENTER SOUTH
402 WEST WASHINGTON STREET
INDIANAPOLIS, INDIANA 46204
317-232-3000

Revisions: 03/28/2023
Added Existing Contours

Project Number: 84003001-22-058-C1

Requestion Number:

Account Number:

Designer: DEH Drawing Date: 02/23/2023

Drafter: MDR Drawing Scale: 1"=30'

DAPW Approval:

Client Approval:

Reference Number: 1364

Building Reference:
Drawing Number: C203
Sheet: 41 of 155

Last Saved By: mreed Printed: 3/28/23
 P:\1364 - Clear Creek Welcome Center\WORKS\SITE SHEETS\518-01-0200 GRADING PLAN.dwg Mar 28, 2023 - 1:00:22 am

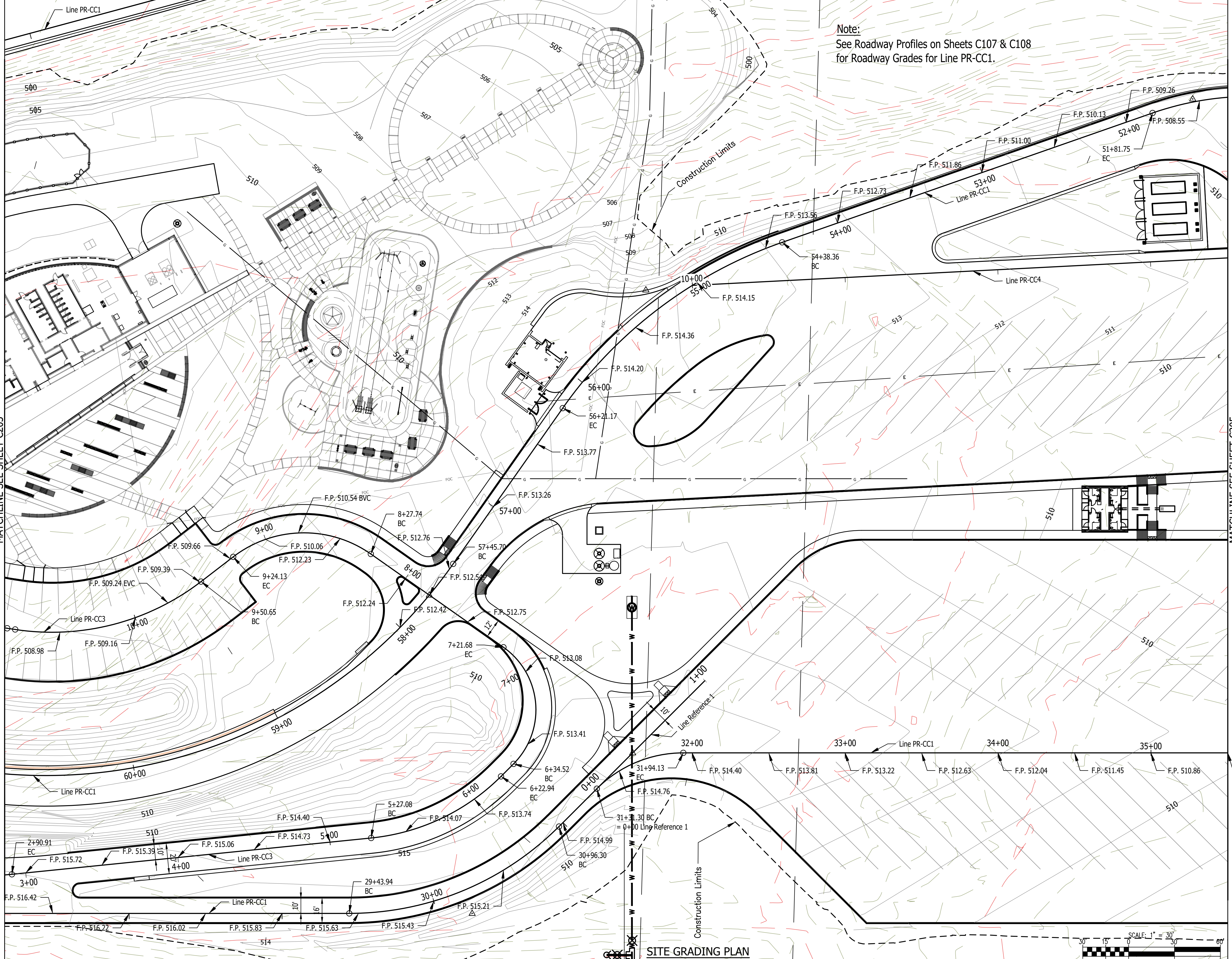

Note:
 See Roadway Profiles on Sheets C107 & C108
 for Roadway Grades for Line PR-CC1.

MATCHLINE SEE SHEET C203

MATCHLINE SEE SHEET C205

SITE GRADING PLAN

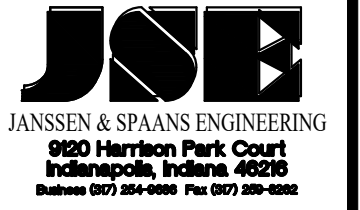
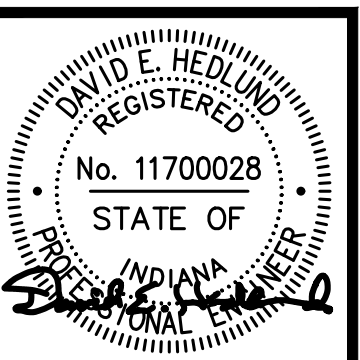

PUBLIC WORKS PROJECT NO. 84003001-22-058-C1
 CLEAR CREEK WELCOME CENTER
 VIGO COUNTY, INDIANA

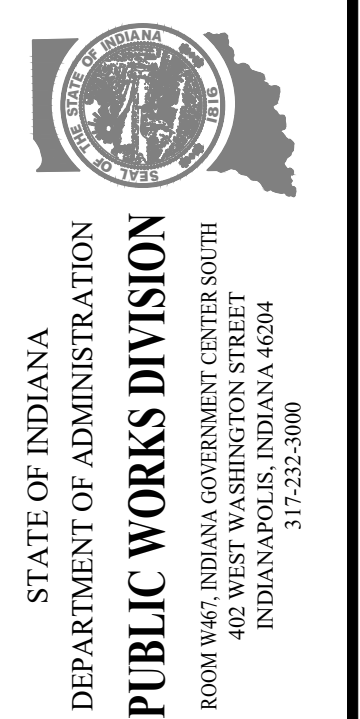

Revisions: 03/28/2023
 Added Existing Contours

Project Number:	84003001-22-058-C1
Requestion Number:	
Account Number:	
Designer:	DEH
Drawing Date:	02/23/2023
Drafter:	MDR
Drawing Scale:	1"=30'
DAPW Approval:	
Client Approval:	
Reference Number:	1364
Building Reference:	
Drawing Number:	C204
Sheet:	42 of 155

Plot Saved By: mreed_Primed3/28/23
P:\1364 - Clear Creek Welcome Center\WORKS\SITE SHEETS\1364-EB-C200 GRADING PLAN.dwg Mar 28, 2023 - 11:00:31 am

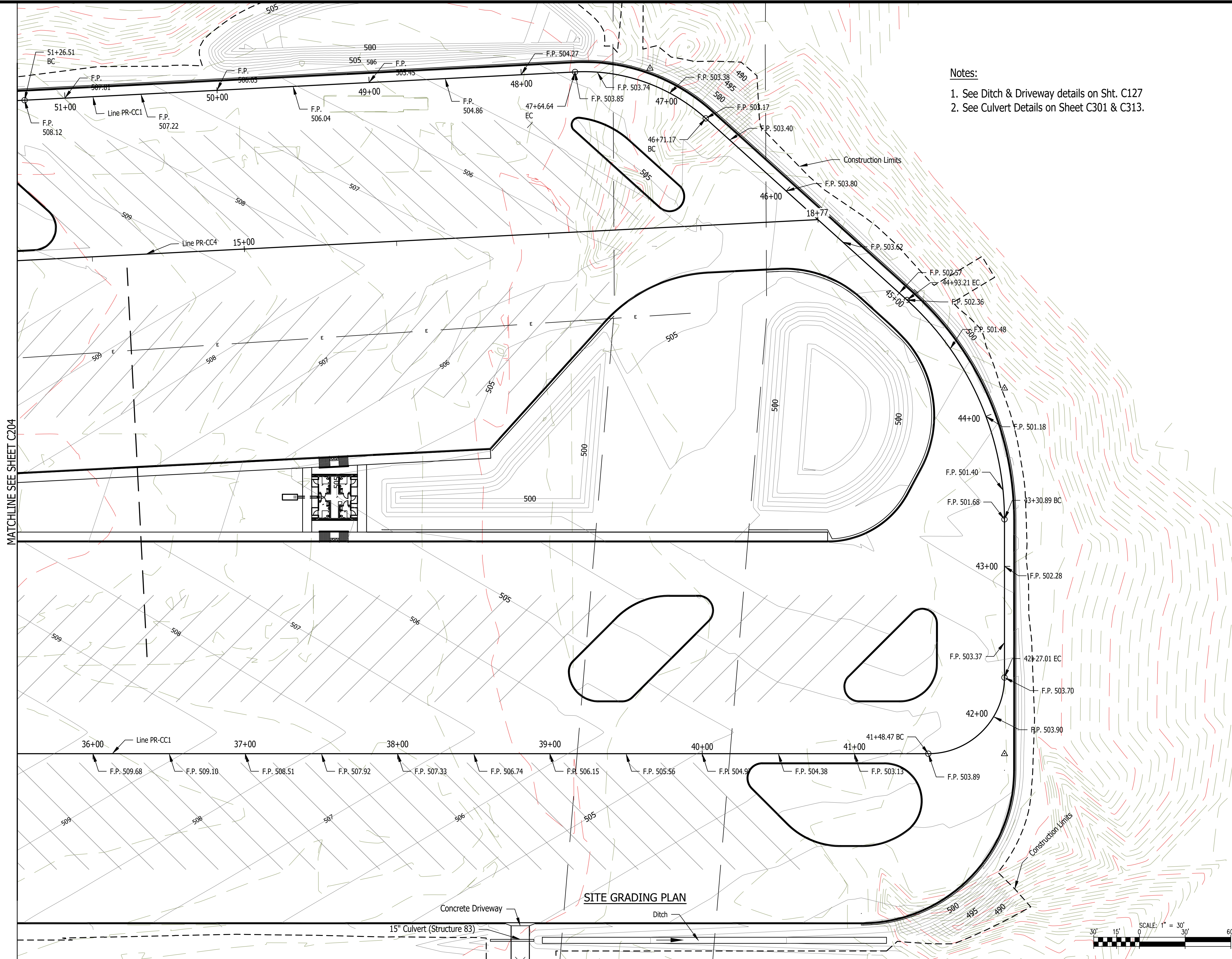

- Notes:
1. See Ditch & Driveway details on Sht. C127
 2. See Culvert Details on Sheet C301 & C313.

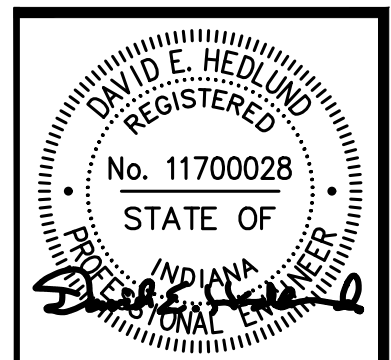
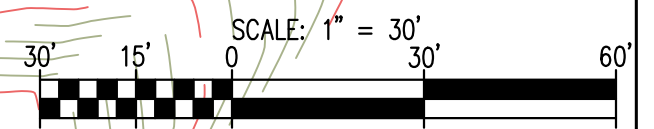
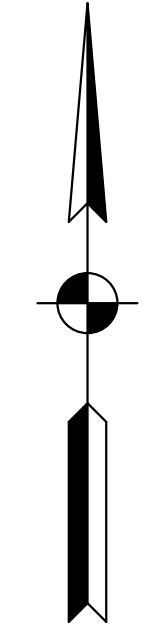

Certified by: David Hedlund
JSE
JANSSEN & SPAANS ENGINEERING
900 Harrison Park Court
Indianapolis, Indiana 46204
Business (317) 252-0000 Fax (317) 252-0000

synthesis
RATIO
LANDSCAPE ARCHITECTURE
101 S Pennsylvania St.
Indianapolis, IN 46204
T: 317.238.4688
www.ratiodesign.com

Applied
Engineering Services







PUBLIC WORKS PROJECT NO. 84003001-22-058-C1
CLEAR CREEK WELCOME CENTER
VIGO COUNTY, INDIANA

STATE OF INDIANA
DEPARTMENT OF ADMINISTRATION
PUBLIC WORKS DIVISION
ROOM 9402, INDIANA GOVERNMENT CENTER SOUTH
402 WEST WASHINGTON STREET
INDIANAPOLIS, INDIANA 46204
317-232-3000

Revisions: 03/28/2023
Added Existing Contours

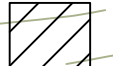
Project Number:	84003001-22-058-C1
Requestion Number:	
Account Number:	
Designer:	DEH
Drawing Date:	02/23/2023
Drafter:	MDR
Drawing Scale:	1"=30'
DAPW Approval:	
Client Approval:	
Reference Number:	1364
Building Reference:	
Drawing Number:	C205
Sheet:	43 of 155

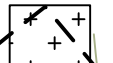
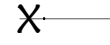
LEGEND

-  PAVEMENT REMOVAL
-  SIDEWALK REMOVAL
-  BUILDING REMOVAL
-  TREE REMOVAL
-  SHRUB & GRASS REMOVAL
-  WATER PLANT REMOVAL
-  UTILITY REMOVAL
-  EXISTING CONTOUR
-  SOIL BORING
SEE GEOTECHNICAL ENGINEERING STUDY
FOR FURTHER EXPLANATION.

SEC. 34 T12N, R10W
SUGAR CREEK TOWNSHIP
VIGO COUNTY

EB 1-70

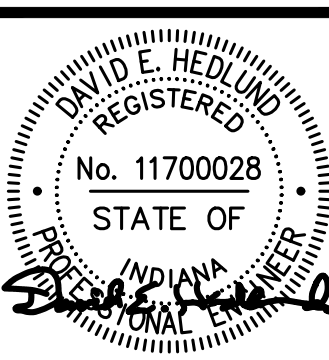
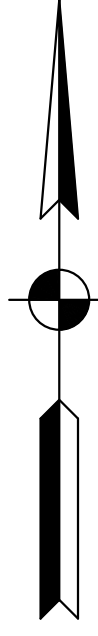
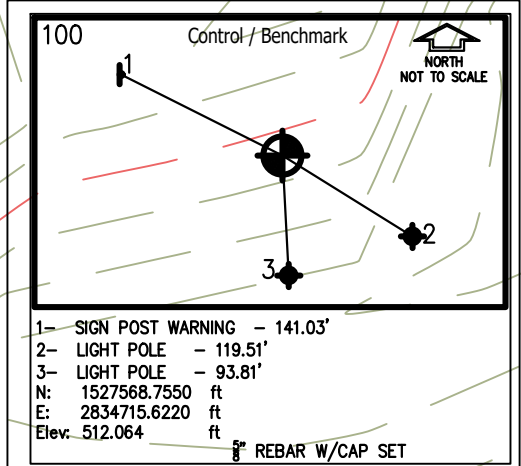

PUBLIC WORKS PROJECT NO. 84003001-22-058-C1
CLEAR CREEK WELCOME CENTER
VIGO COUNTY, INDIANA

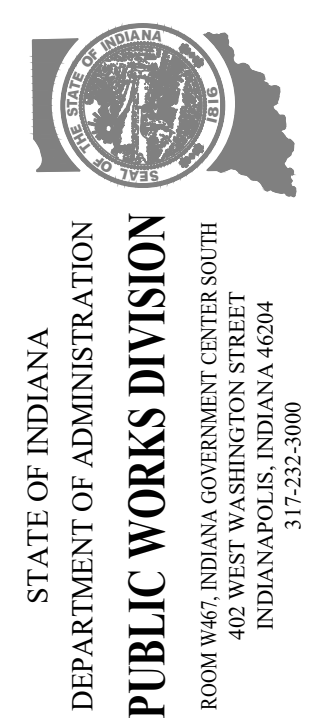

Revisions: 03/28/2023
Revised location of Stockpile, Field Office & Concrete Washout & Added Existing Contours

Project Number:	84003001-22-058-C1
Requestion Number:	
Account Number:	
Designer:	DEH
Drawing Date:	02/23/2023
Drafter:	MDR
Drawing Scale:	1"=30'
DAPW Approval:	
Client Approval:	
Reference Number:	1364
Building Reference:	
Drawing Number:	C206
Sheet:	44 of 155

Last Saved By: mreed Printed: 3/29/23
 P:\1364 - Clear Creek Welcome Center\WORKS SITE SHEETS\EB WELCOME CENTER\1364-EB-C200 GRADING PLAN.dwg Mar 28, 2023 - 1:00:40 pm

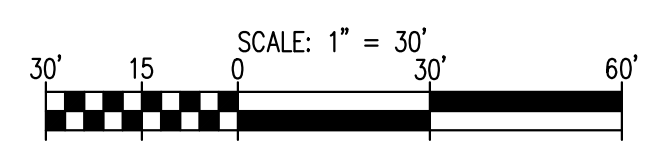
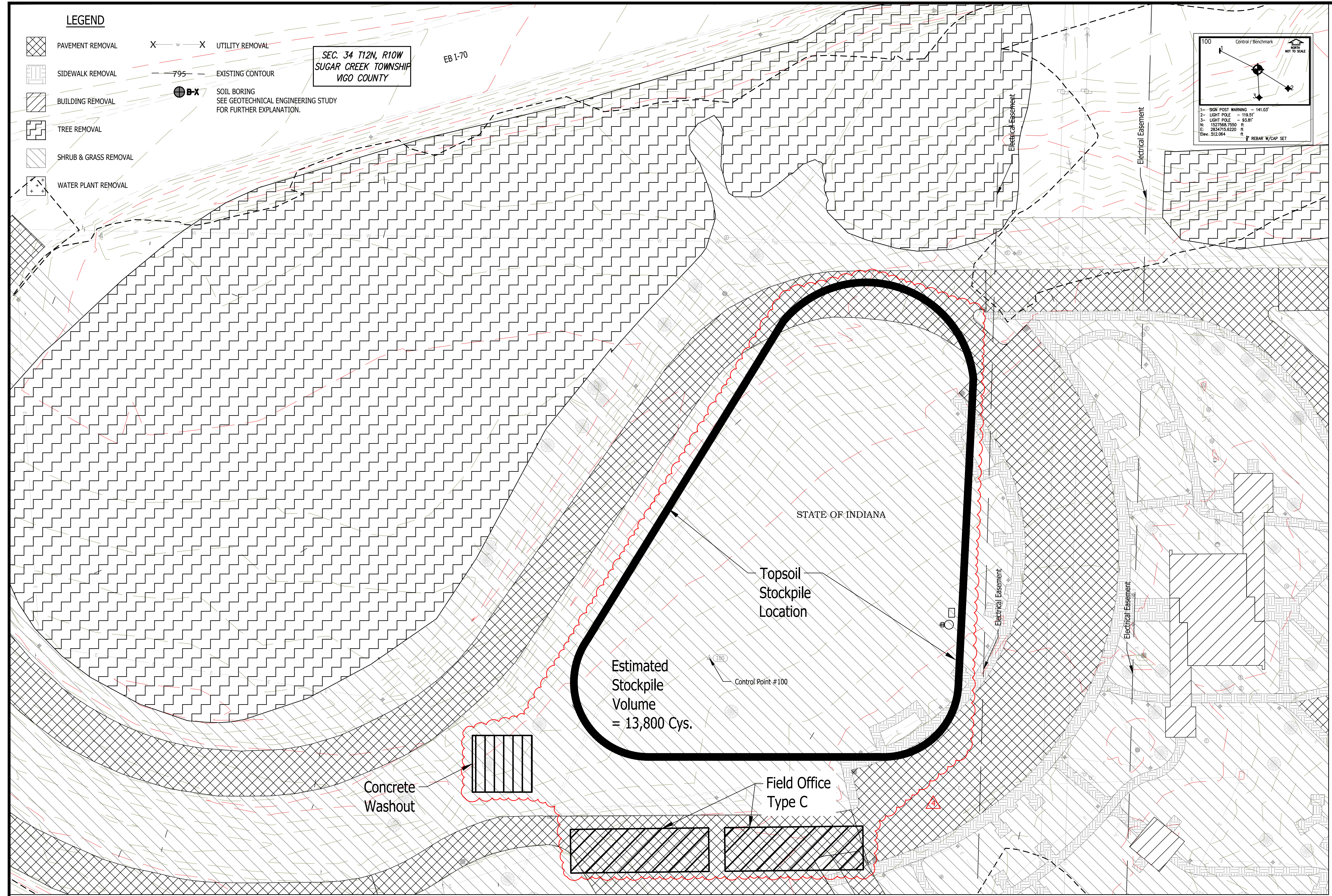

General Notes:

1. Contractor shall furnish and install conduit for proposed electric/fiber optic utilities as shown on plan sheets C400 - C401. Conduit shall be 2" Schedule 80 PVC unless otherwise specified.
2. Conduit from the 3-Phase electric line from the Duke Energy tower to the transformer pad location shall be 4" Schedule 80 PVC.
3. Onsite gas lines shall be furnished and installed in accordance with CenterPoint Energy Standards.
4. Route electric conduits to avoid trees. See Landscape Plans.

SEC. 34 T12N, R01W
SUGAR CREEK TOWNSHIP
VIGO COUNTY
STATE OF INDIANA

WELCOME CENTER UTILITIES PLAN (FOR REFERENCE ONLY)

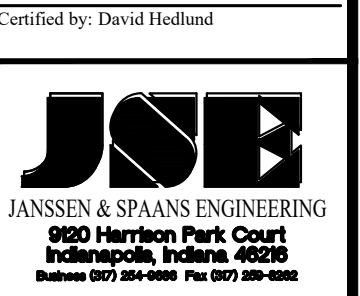
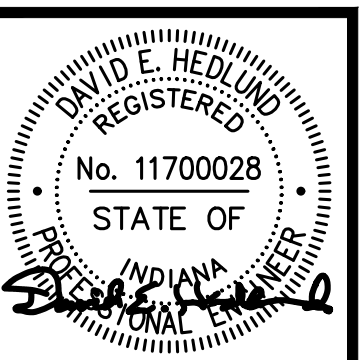

PUBLIC WORKS PROJECT NO. 84003001-22-058-C1
CLEAR CREEK WELCOME CENTER
VIGO COUNTY, INDIANA

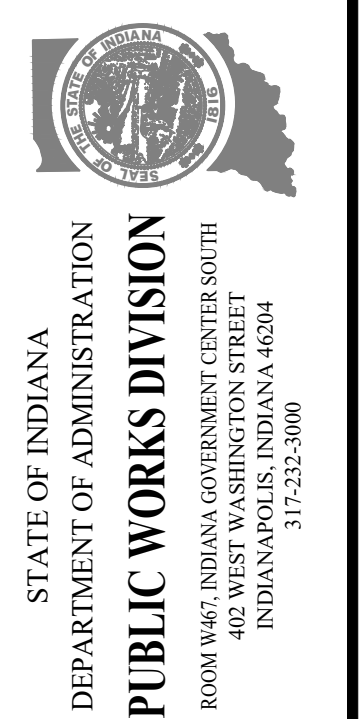

Revisions: 03/28/2023
Deleted Cell Tower & FOC

Project Number:	84003001-22-058-C1
Requestion Number:	
Account Number:	
Designer:	RJS
Drawing Date:	02/23/2023
Drafter:	JRC
Drawing Scale:	1"=50'
Client Approval:	
Reference Number:	1364
Building Reference:	
Drawing Number:	C400
Sheet:	62 of 155

Last Saved By: mreed Printed: 3/28/23
 P:\1364 - Clear Creek Welcome Center\DWG\SITE SHEETS\EB WELCOME CENTER\1364-EB-000 UTILITY PLAN.dwg Mar 28, 2023 - 11:01:41 am

DAVID A. I. &
SALLY DEBNEY

MICHELLE K. WAGLE

MARK & JAMIE
EVERSOLE

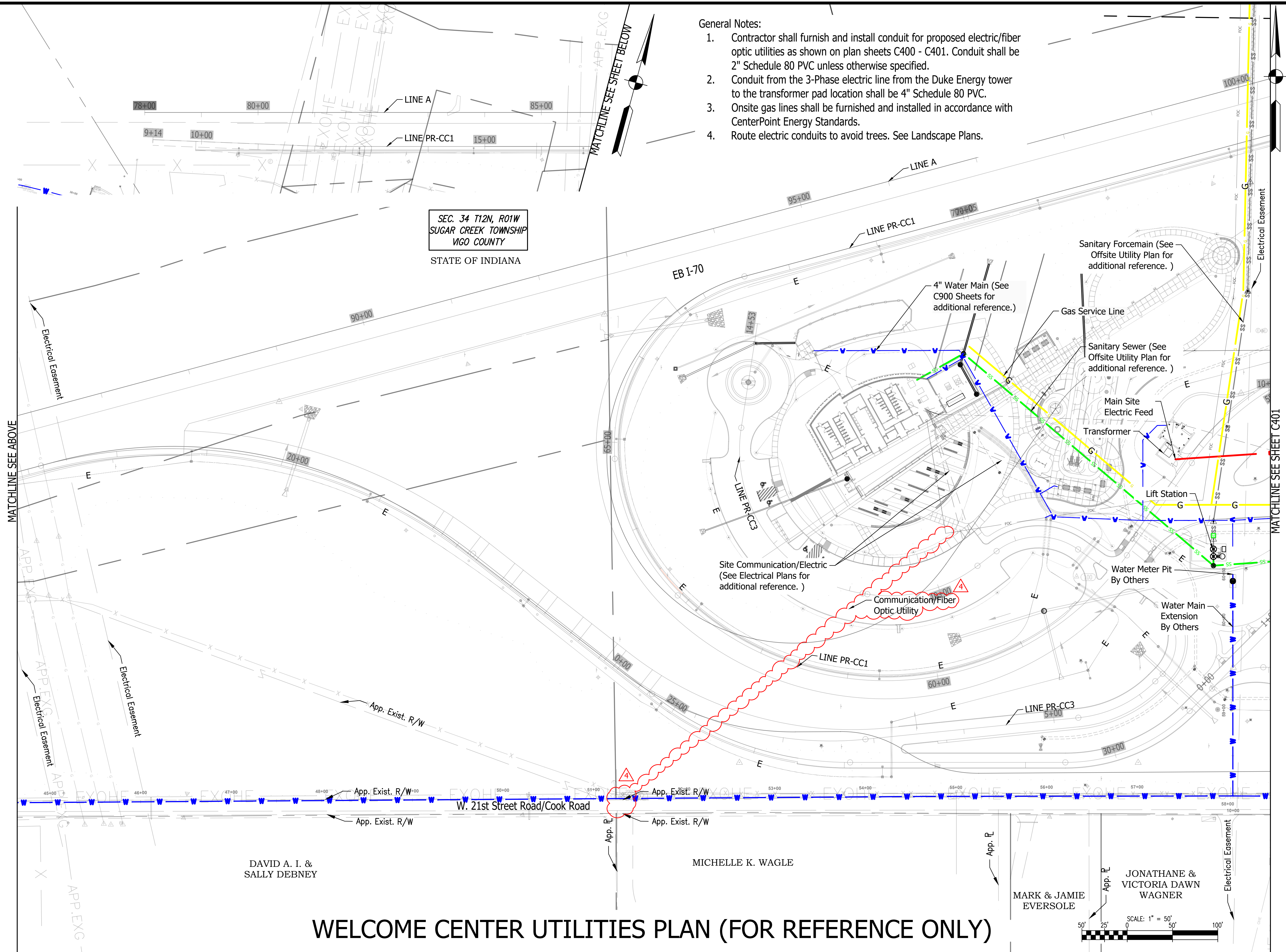
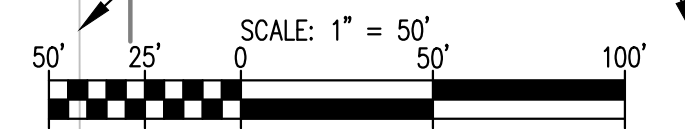

Last Saved By: mreed Printed: 3/28/23
 P:\1364 - Clear Creek Welcome Center\WORKSHEETS\1364-EB-C500 SIGN-PLAN PLANKING Mar 28, 2023 - 11:02:02 am

SHEET SIGN & POST SUMMARY																		
PLAN SHEET NO.	SIGN				POST													
	LOCATION		SIGN CODE	SIGN SIZE (W x H) (in. x in.)	GROUND - MOUNTED SIGN AREA (ft ²)			MOUNTED ON PANEL SIGN, AREA (ft ²)	SQUARE									
	STATION	LINE " "			0.080"	0.100"	0.125"		0.080"	2 1/2" X 2 1/2" - 12 GA. (TYPE 3)			2" X 2" - 12 GA. (TYPE 2)			2 1/4" X 2 1/4" - 12 GA. (TYPE 1)		
										UNREINFORCED ANCHOR			REINFORCED ANCHOR			REINFORCED ANCHOR		
or NORTHING (N); EASTING (E):		POST LENGTH (ft.)			POST LENGTH (ft.)			POST LENGTH (ft.)										
								1	2	TOTAL	1	2.00	TOTAL	1	TOTAL			
C500	N:1527692.9399, E:2833732.0745		R8-3	48 x 48		16.00							9.67	19.34				
C500	N:1527426.3466, E:2834860.2382		R3-9dP	30 x 12	2.50										6.67	6.67		
			R8-3	48 x 48		16.00							9.67	19.34				
			R5-1a	42 x 30		8.75									8.17	8.17		
C500	N:1527423.0765, E:2834863.4891		RX-X	36 x 36		9.00									8.67	8.67		
C500	N:1527443.2395, E:2834843.1636		R5-1a	42 x 30		8.75									8.17	8.17		
C500	N:1527550.7473, E:2834777.2543		R1-1	36 x 36		9.00									8.67	8.67		
C500	N:1527570.2063, E:2834794.8397		R1-1	36 x 36		9.00									8.67	8.67		
C500	N:1527575.7968, E:2834795.9651		R5-1	30 x 30	6.25										8.17	8.17		
C500	N:1527600.3496, E:2834756.5761		R5-1	30 x 30	6.25										8.17	8.17		
C500	N:1527570.4613, E:2834741.3073		R1-1	36 x 36		9.00									8.67	8.67		
C500	N:1527566.3039, E:2834721.5318		R1-1	36 x 36		9.00									8.67	8.67		
C500	N:1527545.4629, E:2834710.3317		RX-X	36 x 36		9.00									8.67	8.67		
C500	N:1527606.4502, E:2834445.7932		R7-8	12 x 18	1.50										7.17	7.17		
C500	N:1527616.6496, E:2834430.6440		R7-8	12 x 18	1.50										7.17	7.17		
C500	N:1527659.3883, E:2834397.0796		R7-8	12 x 18	1.50										7.17	7.17		
C500	N:1527676.5233, E:2834390.7618		R7-8	12 x 18	1.50										7.17	7.17		
C501	N:1527458.6323, E:2835846.1768		R1-2	48x48x48		3.50						8.27	8.27					
C501	N:1527553.1481, E:2835935.8540		R1-2	48x48x48		3.50						8.27	8.27					
C501	N:1527845.4469, E:2835078.7817		R1-2	48x48x48		3.50						8.27	8.27					
C501	N:1527625.0767, E:2834902.5258		R1-2	48x48x48		3.50						8.27	8.27					
C500	N:1527379.6319, E:2834546.4413		IGS-1	96x60			24.00			8.67	17.34							
C500	N:1527737.0837, E:2833775.3991		IGSS-2	78x78		42.25						12.17	24.34					
Total (Current Sheet)						21.00	159.75	24.00			8.67	17.34	33.08	31.51	96.10		120.05	

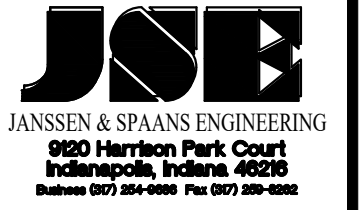
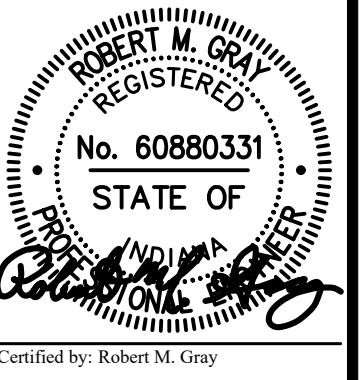

PUBLIC WORKS PROJECT NO. 84003001-22-058-C1
 CLEAR CREEK WELCOME CENTER
 VIGO COUNTY, INDIANA

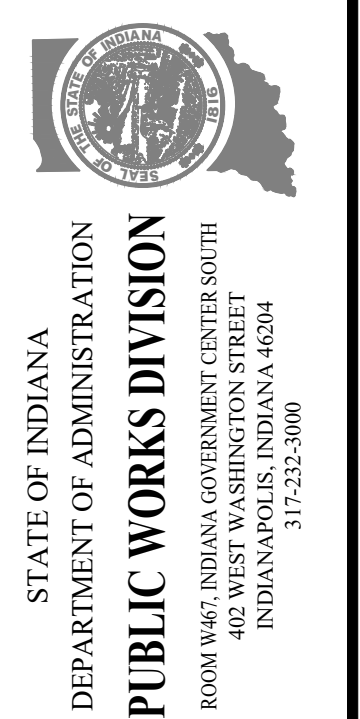

Revisions: 03/28/2023
 Added Sign Post Data

Project Number: 84003001-22-058-C1
 Requisition Number:
 Account Number:
 Designer: TAF Drawing Date: 02/23/2023
 Drafter: PKA Drawing Scale: N/A
 DAPW Approval:
 Client Approval:
 Reference Number: 1364
 Building Reference:
 Drawing Number: C503
 Sheet: 68 of 155

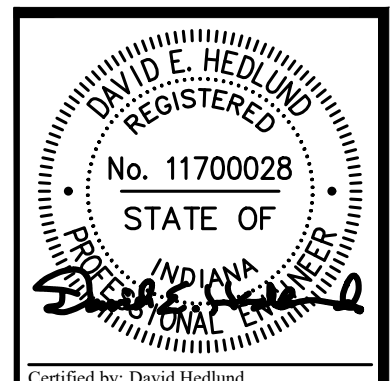

JSE
JANSSEN & SPAANS ENGINEERING
900 Harrison Park Court
Indianapolis, Indiana 46204
Business (317) 258-0800 Fax (317) 258-0801

synthesis

RATIO
LANDSCAPE ARCHITECTURE
101 S. Pennsylvania St.
Indianapolis, IN 46204
T: 317.238.4688
www.ratiodesign.com

Applied
Engineering Services

PUBLIC WORKS PROJECT NO. 84003001-22-058-C1
CLEAR CREEK WELCOME CENTER
VIGO COUNTY, INDIANA

STATE OF INDIANA
DEPARTMENT OF ADMINISTRATION
PUBLIC WORKS DIVISION
ROOM W402, INDIANA GOVERNMENT CENTER SOUTH
402 WEST WASHINGTON STREET
INDIANAPOLIS, INDIANA 46204
317-232-3000

Revisions: 03/28/2023
Revised location of Stockpile, Field Office & Concrete Washout

Project Number: 84003001-22-058-C1
Requestion Number:
Account Number:
Designer: RJS Drawing Date: 02/23/2023
Drafter: JRC Drawing Scale: 1"=50'
DAPW Approval:
Client Approval:
Reference Number: 1364
Building Reference:
Drawing Number: C700
Sheet: 77 of 155

SEC. 34 T12N, R10W
SUGAR CREEK TOWNSHIP
VIGO COUNTY

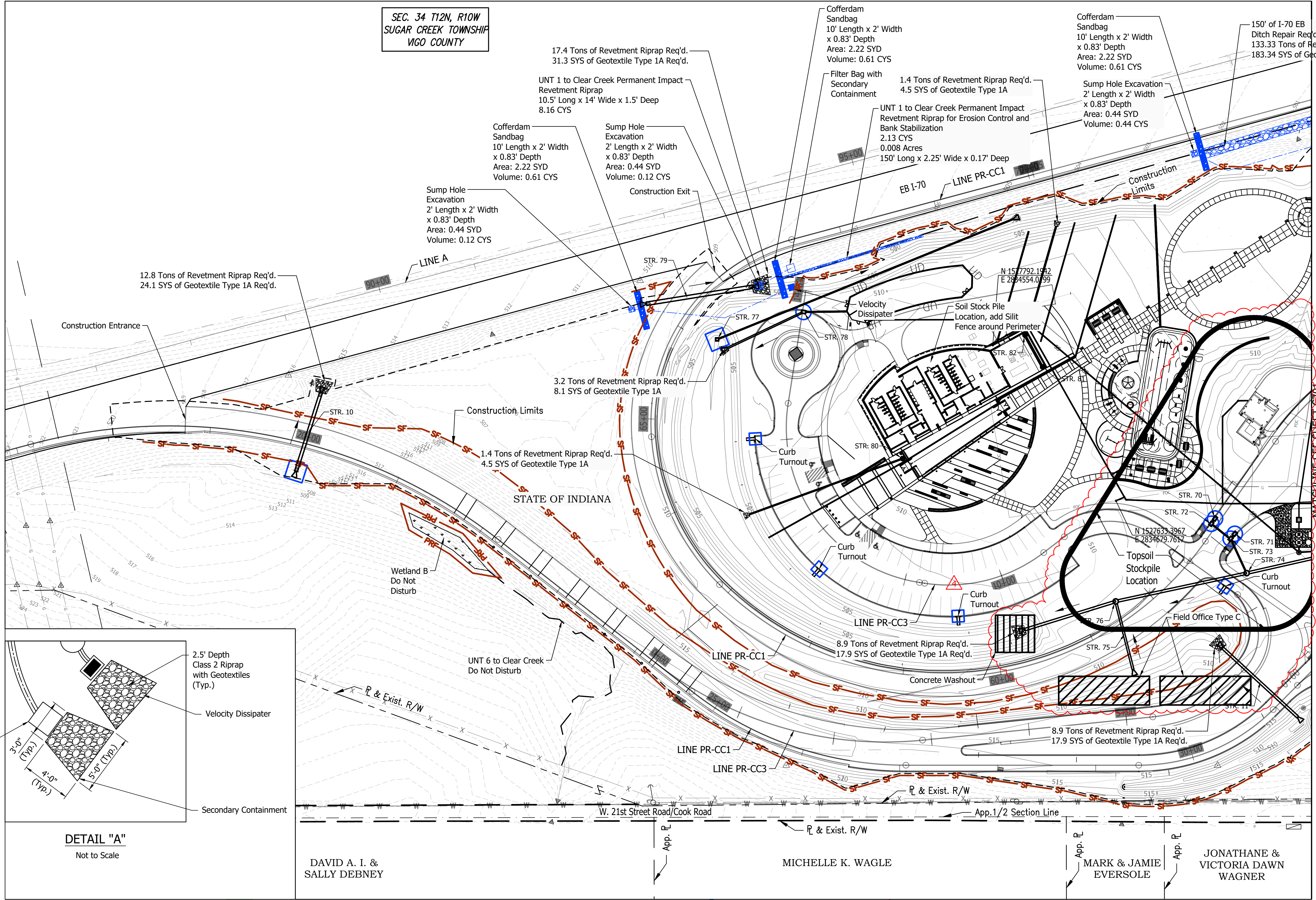

12.8 Tons of Revetment Riprap Req'd.
24.1 SYS of Geotextile Type 1A Req'd.

17.4 Tons of Revetment Riprap Req'd.
31.3 SYS of Geotextile Type 1A Req'd.

Cofferdam Sandbag
10' Length x 2' Width x 0.83' Depth
Area: 2.22 SYD
Volume: 0.61 CYS

Cofferdam Sandbag
10' Length x 2' Width x 0.83' Depth
Area: 2.22 SYD
Volume: 0.61 CYS

150' of I-70 EB Ditch Repair Req'd.
133.33 Tons of Revetment Riprap Req'd.
183.34 SYS of Geotextile Type 1A Req'd.

UNT 1 to Clear Creek Permanent Impact Revetment Riprap
10.5' Long x 14' Wide x 1.5' Deep
8.16 CYS

Cofferdam Sandbag
10' Length x 2' Width x 0.83' Depth
Area: 2.22 SYD
Volume: 0.61 CYS

Sump Hole Excavation
2' Length x 2' Width x 0.83' Depth
Area: 0.44 SYD
Volume: 0.12 CYS

Sump Hole Excavation
2' Length x 2' Width x 0.83' Depth
Area: 0.44 SYD
Volume: 0.12 CYS

1.4 Tons of Revetment Riprap Req'd.
4.5 SYS of Geotextile Type 1A

Sump Hole Excavation
2' Length x 2' Width x 0.83' Depth
Area: 0.44 SYD
Volume: 0.44 CYS

Construction Entrance

3.2 Tons of Revetment Riprap Req'd.
8.1 SYS of Geotextile Type 1A

1.4 Tons of Revetment Riprap Req'd.
4.5 SYS of Geotextile Type 1A

Wetland B
Do Not Disturb

UNT 6 to Clear Creek
Do Not Disturb

8.9 Tons of Revetment Riprap Req'd.
17.9 SYS of Geotextile Type 1A Req'd.

8.9 Tons of Revetment Riprap Req'd.
17.9 SYS of Geotextile Type 1A Req'd.

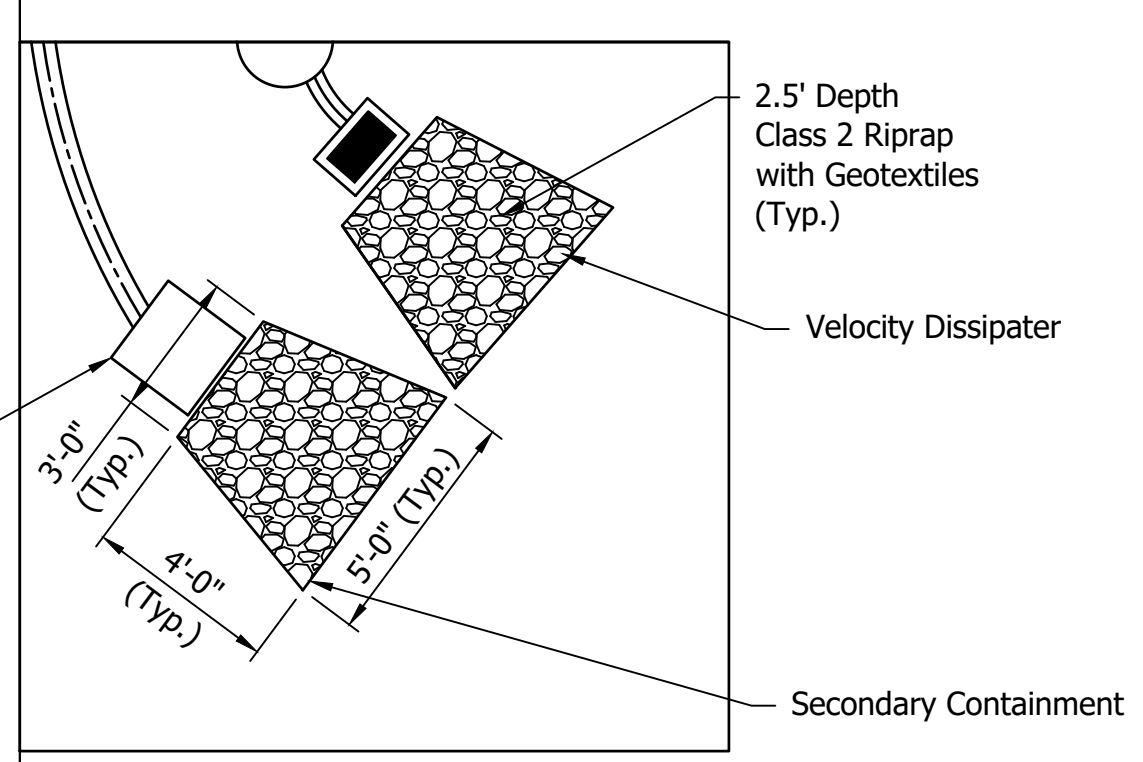

DETAIL "A"
Not to Scale

LEGEND

SF	Temporary Silt Fence (As Req'd)	Temporary Seed and Mulch	Temporary Check Dam, Revetment Riprap	Temporary Sediment Trap	Do Not Mow or Spray Sign
FS	Temporary Filter Sock (As Req'd)	Manufactured Surface Protection Product	Temporary Check Dam, Traversable, Low Profile	Permanent Revetment Riprap	
PRF	Protected Resource Fencing	Wetland Area	Ditch Inlet Protection	Offsite Flow Direction	
Ditch Flowline	Ditch Flowline (Existing or Other Phase/Proposed)	Area Under Construction	Inlet Protection	Dry Native Grass Seed Mixture	

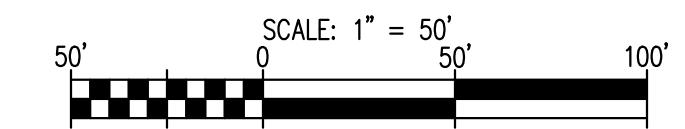

Plot Saved By: mreed PrintDate: 3/29/23 File: C:\Users\mreed\OneDrive\Documents\1364-EB-C700 SWM Plan.dwg Mar 28, 2023 - 1:02:57 pm

Last Saved By: mreed Printed: 2/28/23
 P:\1364 - Clear Creek Welcome Center\GIS\SITE SHEETS\EB WELCOME CENTER\1364-EB-C700 SWM PLAN.dwg Mar 28, 2023 - 1:03:07 pm

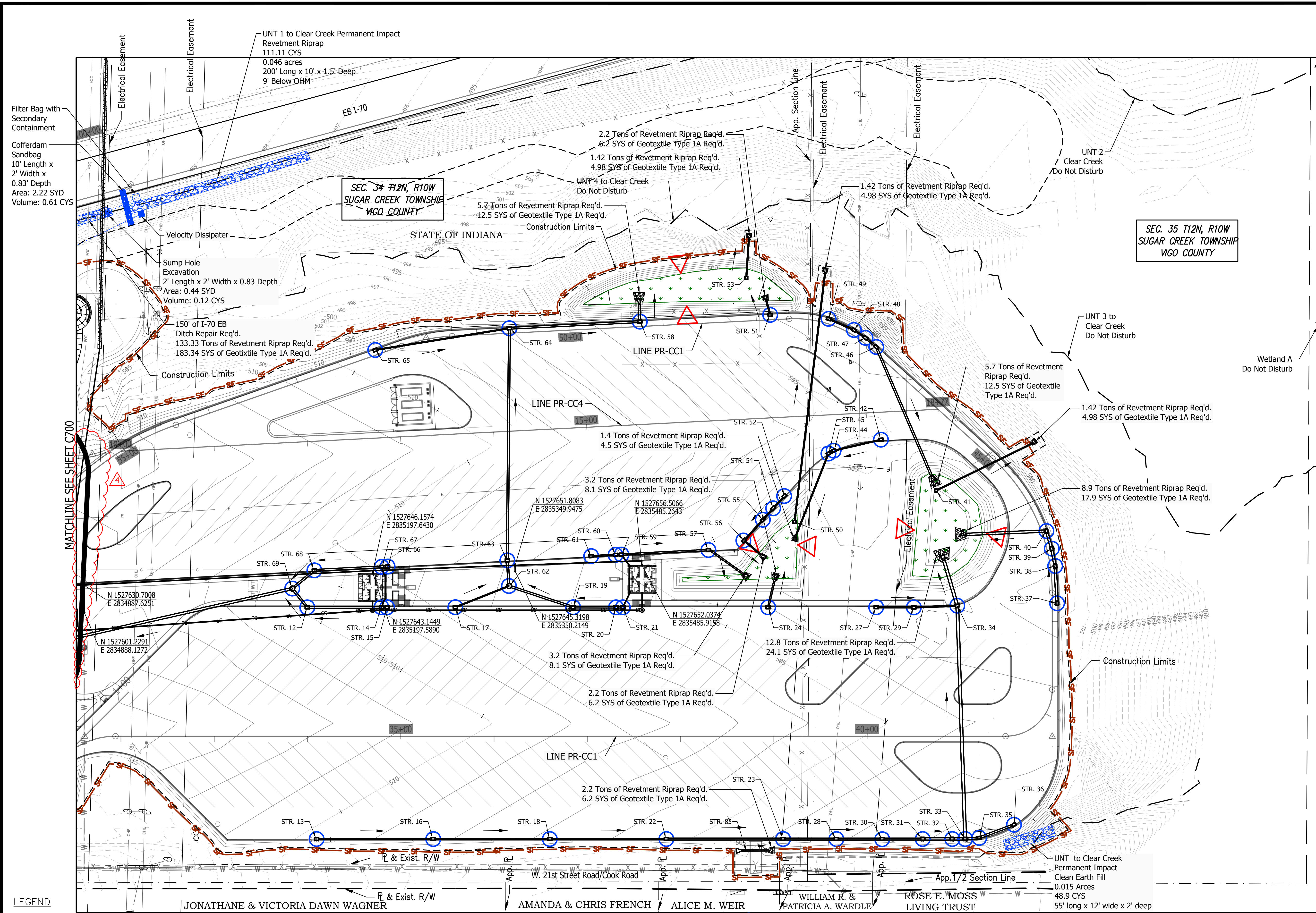

LEGEND	
	Temporary Silt Fence (As Req'd)
	Temporary Filter Sock (As Req'd)
	Protected Resource Fencing
	Ditch Flowline (Existing or Other Phase/Proposed)
	Temporary Seed and Mulch
	Manufactured Surface Protection Product
	Wetland Area
	Area Under Construction
	Temporary Check Dam, Riprap
	Temporary Check Dam, Traversable, Low Profile
	Ditch Inlet Protection
	Inlet Protection
	Temporary Sediment Trap
	Permanent Riprap
	Offsite Flow Direction
	Dry Native Grass Seed Mixture
	Do Not Mow or Spray Sign

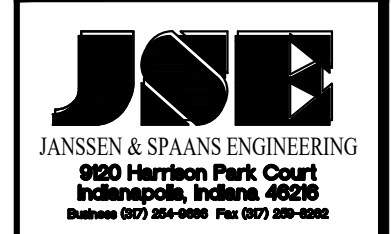
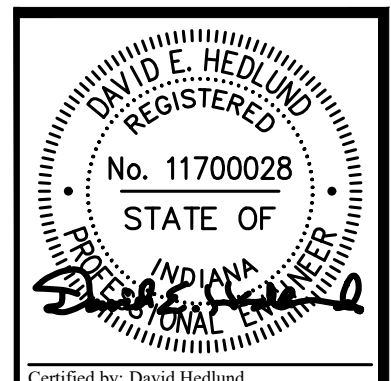
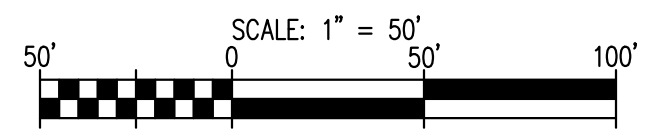

PUBLIC WORKS PROJECT NO. 84003001-22-058-C1
 CLEAR CREEK WELCOME CENTER
 VIGO COUNTY, INDIANA



Revisions: 03/28/2023	Revised location of Stockpile
Project Number:	84003001-22-058-C1
Requestion Number:	
Account Number:	
Designer:	RJS
Drawing Date:	02/23/2023
Drafter:	JRC
Drawing Scale:	1"=50'
DAPW Approval:	
Client Approval:	
Reference Number:	1364
Building Reference:	
Drawing Number:	C701
Sheet:	78 of 155